



Origin Acoustics Outdoor Collection

Ambisonic Hexagonal Surface Mount Speakers



ASM63CH



ASM63SUB-CH



ASM63S

ASM63 • ASM63SUB

The Ambisonic Surface Mount Speaker Series, comprised of one modular surface mount landscape speaker with a 6 ½" driver, is now newly available in the new hexagonal design, plus three new colors to complement any outdoor environment. As timeless as ever, the versatile and modular design allows for this single speakers to be coupled up as double or even triple stack arrays.

Ambisonic Systems has delivered high performance experiences in luxury outdoor settings for decades. The new series of hexagonal Ambisonic Landscape Surface Mounts proudly feature the same proprietary technologies and quality materials.

Each high definition, ultra-high fidelity full range surface mount speaker features Ambisonic Systems' proprietary acoustic technology: a 3" high-performance Planar Magnetic Ribbon Tweeter - for superior high frequency reproduction and clarity with lower distortion at higher power levels, - and a 6.5" Glass Fiber woofer in a true coaxial configuration. The ASM63SUB Subwoofer models offer a generous 8" woofer to boost the bass.

Using high-quality materials and a modular yet timeless design makes it easy to dismantle, refurbish or replace critical components and ensures that the speakers can be kept in use longer.

We recommend installing with Origin PRO Amplifiers for a seamless, optimal listening experience, with ready-to-go, dedicated DSP profiles.

Scan the QR Code for full instructions for this product.



Ultra-Fast Dynamic Range

All Ambisonic landscape speakers offer ultra-fast transient response and a higher instantaneous peak level for faithful signal reproduction and improved dynamic range.

Wider Dispersion & Coaxial Drivers

All Ambisonic surface mounts feature a Coaxial design for not just wider dispersion and larger listening area, but also excellent stereo imaging.

Proprietary Waveguides

Each speaker boasts a highly efficient planar ribbon driver, with proprietary waveguide, and ultra-sensitive aluminum diaphragm, featuring a high-performance, audiophile-grade, weatherized ribbon tweeter. All unique to Ambisonic. All energized by a neodymium motor to accentuate your audio signals into the ultimate high fidelity reproduction, with minimal distortion. You'll need to hear to believe it.

Acoustic Aluminum

The hexagonal speaker sleeves are crafted using premium aluminum for its superior acoustic properties, ability to withstand harsh outdoor elements while maintaining the aluminum's natural beauty, and sustainability benefits for the environment. The aluminum enclosure houses all-weather, waterproof driver components: stainless steel, powder coated hardware.



ASM63SUB-S



ASM63BL



ASM63SUB-BL



IP66 Outdoor Resilience

The compact, trapezoidal all weather, molded composite enclosure with an IP-66 rating, has been designed with the unique waveguide to deliver excellent dispersion and fidelity.

Rock Solid Amplification

Pair any system with an **Origin PRO Amplifier** for custom DSP profiles to optimize performances. Built to deliver the necessary horsepower in 8 ohm, the Origin PRO Amplifiers are capable of driving any extensive outdoor audio set up to levels that hit straight down to the *bones*.

Bring to life those important key transients and higher frequency nuances, for a stunningly powerful, outdoor sound immersion experience, promising crystal clear, wide dispersion sound yet minimal distortion at high volumes. These amps will allow you to reap the full benefit of Ambisonic audio technology.



ASM63WH



ASM63SUB-WH



ORIGIN PRO AMPLIFIERS



Specifications

Champagne Speaker Models:

ASM63CH • ASM63SUB-CH

Silver Speaker Models:

ASM63S • ASM63SUB-S

Black Speaker Models:

ASM63BL • ASM63SUB-BL

White Speaker Models:

ASM63WH • ASM63SUB-WH

1A

ASM63

- 3" Magnetic Planar Ribbon Driver
- 6 ½" All-Weather Glass Fiber Cone Woofer
- Rated Impedance: 8 Ohm

1B

ASM63SUB

- 8" Polypropylene Cone Woofer
- Rated Impedance: 8 Ohm

SPECIFICATIONS

System Type

Driver Components

Frequency Response

SPL @1m

System Coverage

Sensitivity, 1m/2.83V

Power Handling

Recommended Amp Power

Impedance

Input Connectors

Mounting

Dimensions (w/out mounts)

ASM63

Indoor/ Outdoor Universal Surface Mount Speaker

All-Weather 6 ½" Glass Fiber Cone Woofer

3" Planar Magnetic Ribbon Driver

51Hz - 20kHz (-10db) | 74Hz - 20kHz (+/- 3db)

112dB Continuous, 115dB Program, 118dB Peak

100° Horizontal | 60° Vertical

92dB

100W Continuous / 200W Program / 400W Peak

100W - 400W @ 8 Ohms

8 Ohm

Phoenix Connectors

U-bracket with Tilt (Horizontal Install only) or

Pan (Vertical Install only)

10 ¾" H x 14" W x 7 ⅞" D

(259mm H x 356 mm W x 191 mm D)

SPECIFICATIONS

System Type

Driver Components

Frequency Response

SPL @1m

Sensitivity, 1m/2.83V

Power Handling

Recommended Amp Power

Impedance

Input Connectors

Mounting

Dimensions (w/out mounts)

ASM63SUB

Indoor/ Outdoor Universal Surface Mount Subwoofer

All-Weather 8" Polypropylene Cone Woofer

28Hz - 300Hz (-10db) | 37Hz - 300Hz (+/- 3db)

112dB Continuous, 115dB Program, 118dB Peak

91dB

150W Continuous / 300W Program / 600W Peak

100W - 600W @ 8 Ohms

8 Ohm

Phoenix Connectors

U-bracket with Tilt (Horizontal Install only) or Pan

(Vertical Install only)

10 ¾" H x 14" W x 7 ⅞" D

(259mm H x 356 mm W x 191 mm D)

Ambisonic Surface Mount Speakers should be installed with Origin PRO Amplifiers for a seamless, optimal listening experience, with ready-to-go, dedicated DSP profiles.

Specification Details

1A ASM63 LINEDRAWINGS

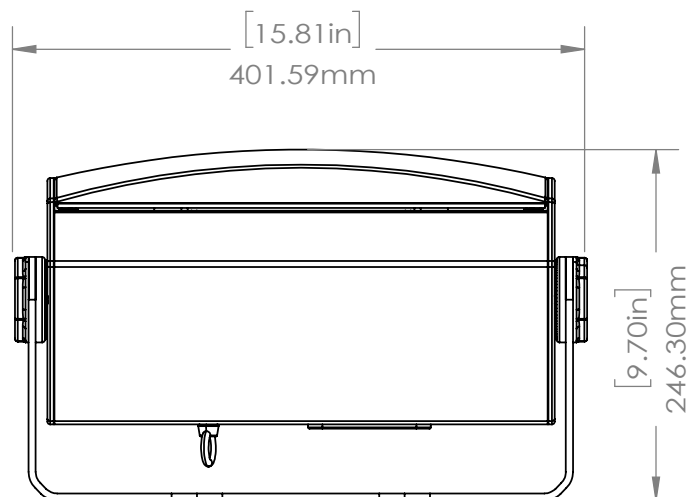
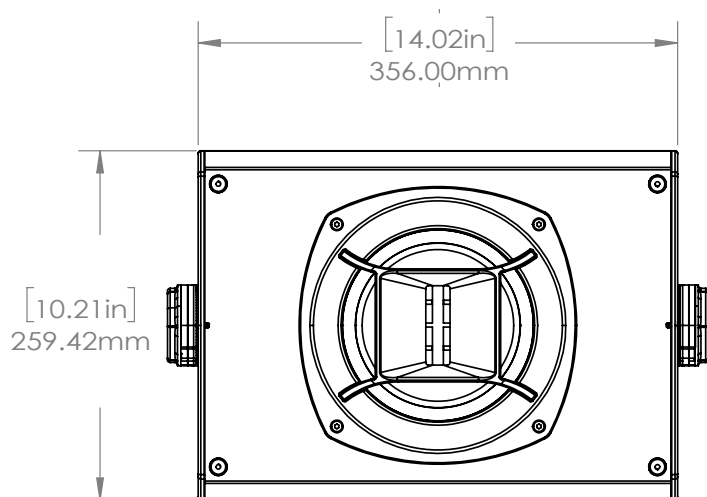
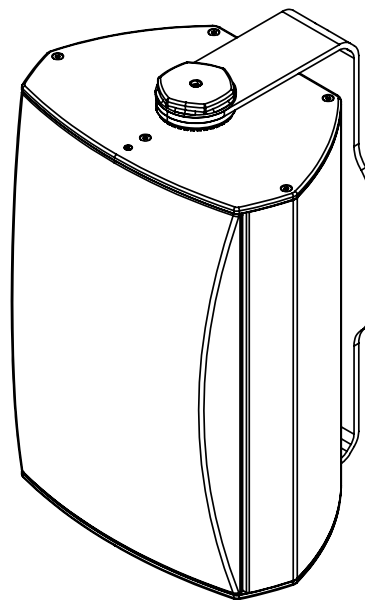
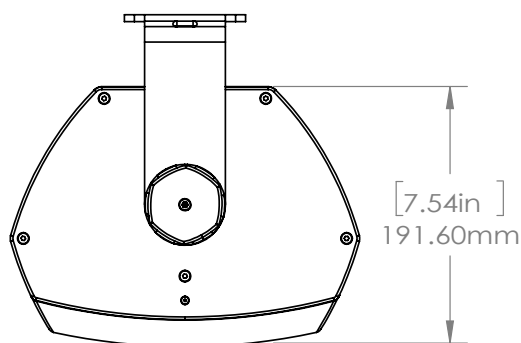

Specification Details

1B ASM63SUB LINEDRAWINGS

