



Origin Acoustics Home Cinema Collection

Ambisonic Marquee Dedicated Home Theater Systems



AM5600OW



AM5600IW



AM3600OW

High Performance Planar Ribbon Home Theater

Ambisonic Systems' first dedicated High-Performance Planar Ribbon Home Theater System is the latest revolution within home theater: a combination of sound and look, unparalleled in design and construction.

Ambisonic Systems has delivered high performance experiences in luxury outdoor settings for decades. The new Ambisonic Marquee home theater system features the same proprietary technologies and quality materials for dedicated home theaters.

On-Wall Speaker Models:

AM5600OW • AM3600OW • AMD10OWSUB • AM650OWA

In-Wall Speakers Models:

AM5600IW • AM3600IW • AMD10IWSUB • M2500IC

The Ambisonic Marquee Home Theater System is comprised of:

- L/C/R Front Speakers (Bi-Amped) (On Or In Wall): AM5600
- Surround Speakers (On Or In Wall): AM3600
- 10" In-Wall Subwoofers (On Or In Wall): AMD10SUB
- Angled Surround Speakers (On Wall Only): AM650OWA (Coming Soon)
- *Complimented by:* M2500IC In-Ceiling Speakers

Ambisonic Marquee Home Theater Systems must be installed with Origin PRO Amplifiers with ready-to-go dedicated DSP profiles, for a seamless, optimal listening experience.

Scan the QR Code for full instructions for this product.





PREMIUM MATERIALS

The enclosures for the Ambisonic Marquee speakers and subwoofer are made of premium and durable extruded aluminum; all are available in both slim on-wall and discrete in-wall configurations, except for the on-wall AM650OWA, which is made of MDF.



ON-WALL OR IN-WALL

The bi-amped AM5600 L/C/R front speakers, AM3600 surround speakers, and AMD10 10" subwoofers are available as in-wall versions.

Display the Marquee Cinema speakers proudly or hide the away. The front, side and rear channels are all complimented by dedicated, extruded aluminum enclosures. You can be confident the sound will remain consistent for both on-wall and in-wall installation options, so the dedicated home theater can match the desired design aesthetic.



TIMBRE-MATCHED

The full Ambisonic Marquee system is timbre-matched. The subwoofer, with the robust Ambisonic planar ribbon tweeter & wave-guide technology, triggers the most primal emotional responses, establishing a sonic foundation upon which the entire Marquee system is built.

The in-ceiling shares the same dynamic response and lifelike nuance in an in-ceiling format. It is the perfect complimentary choice for side/rear channels when the architectural design demands.



AM3600IW



AMD10OWSUB

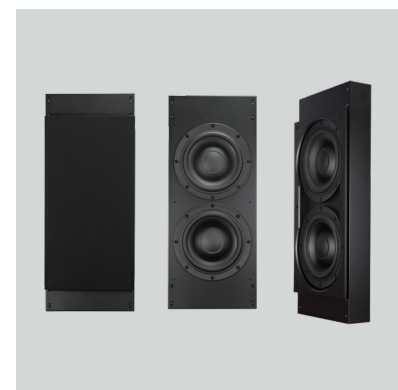

AMD10IWSUB





NON-COMPROMISE

A non-compromise loudspeaker and amplification solution for high-end residential integration, sonic booming performance, and unique cinema-desired looks.



PLANAR RIBBON TECHNOLOGY

In classic Ambisonic style, each speaker features our highly efficient, ribbon driver with proprietary wave-guide: an ultra-sensitive aluminum diaphragm, energized by a neodymium motor, to accentuate your audio signals into the ultimate high fidelity reproduction with minimal distortion.

The Marquee Home Theater system was designed and constructed for an exquisite listening experience - bringing the cinema straight into homes. Witness deeply important key transients and higher frequency nuances to transport listeners (and viewers) directly into the action.



ROCK SOLID AMPLIFICATION

Pair this system with any **Origin PRO Amplifier** for custom DSP profiles to optimize performances. Built to deliver the necessary horsepower to drive the system, the Origin PRO Amplifiers will drive these loudspeakers and woofers to levels that hit straight down to the *bones*.

The AM5600 LCR Speakers can be actively bi-amped with Origin PRO amps, both with DSPs specially crafted for the Ambisonic Marquee system.



IN-WALL MOUNTS



PLANAR RIBBON



ORIGIN PRO AMPLIFIERS

Scan the QR Code for full instructions for this product.





SPECIFICATIONS

1

LCR SPEAKERS

**AM5600 Front of House LCR speakers (bi-amped)
(On-Wall or In-Wall)**

- 3" Magnetic Planar Ribbon Tweeter with Exclusive Waveguide
- 2 x 5 1/4" Woven Fiberglass Mid-Woofer
- 2 x 8" Woven Fiberglass Woofers
- Rated Impedance: 4 ohms

2

SURROUND SPEAKERS

AM3600 Surround speakers (On-Wall or In-Wall)

- 3" Magnetic Planar Ribbon Tweeter
- 2 x 5 1/4" Woven Fiberglass Woofers
- Rated Impedance: 4 ohms

3

DUAL 10" SUBWOOFERS

AMD10 Subwoofer delivers maximum power and efficiency (On-Wall or In-Wall)

- 2 x 10" Aluminum Cone Woofers
- At less than 4" deep, it easily fits into standard stud walls
- Rated Impedance: 4 ohms

4

10" IN-CEILING

The M2500IC Marquee In-Ceiling speaker by Origin Acoustics can be positioned toward the listening area. It's designed to compliment the system and fits into the standard 10" cut-out.

- 3/4" Titanium Multi-Motion™ Pivoting Tweeter
- 3 1/2" Coated Paper Mid-Woofer
- 10" Coated Paper Woofer

5

COAXIAL ANGLED SURROUNDS

AM650OWA Angled Surround speakers can be used as height speakers/surround speakers (On-Wall only) - Coming Soon

- 1 1/2" Conical Planar Ribbon Tweeter
- 6 1/2" Paper/ Kevlar Composite Woofer
- Delivers a very linear response extended in both LF and HF range
- Rated Impedance: 8 ohms

Ambisonic Marquee Home Theater Systems must be installed with Origin PRO Amplifiers with ready-to-go dedicated DSP profiles, for a seamless, optimal listening experience.

M

SPECIFICATION DETAILS

1 LCR SPEAKERS

- **Frequency Response:** 32Hz-20KHz (-10dB), 43Hz-20kHz (-3dB)
- **Maximum SPL @ 1m:** 120dB Continuous Program, 123dB Peak
- **System Coverage:** 100 degree Horizontal, 60 degree Vertical
- **Sensitivity, 2.83v/1m:** 94 dB
- **Recommended Amp:** Origin Pro Amplifiers (bi-amped)
- **Rated Impedance:** 4 ohms
- **OW Dimensions:** 43 5/8" H x 13"W x 4 5/16" D (1108 mm H x 330 mm W x 119 mm D)
- **IW Dimensions:** 43 5/8" H x 13"W x 3 7/16" D (3 7/16" Cabinet / 3/4" Wall Faceplate) (1108 mm H x 330 mm W x 88 mm D) (88 mm Cabinet / 20 mm Wall Faceplate)

1A ON-WALL: AM5600W

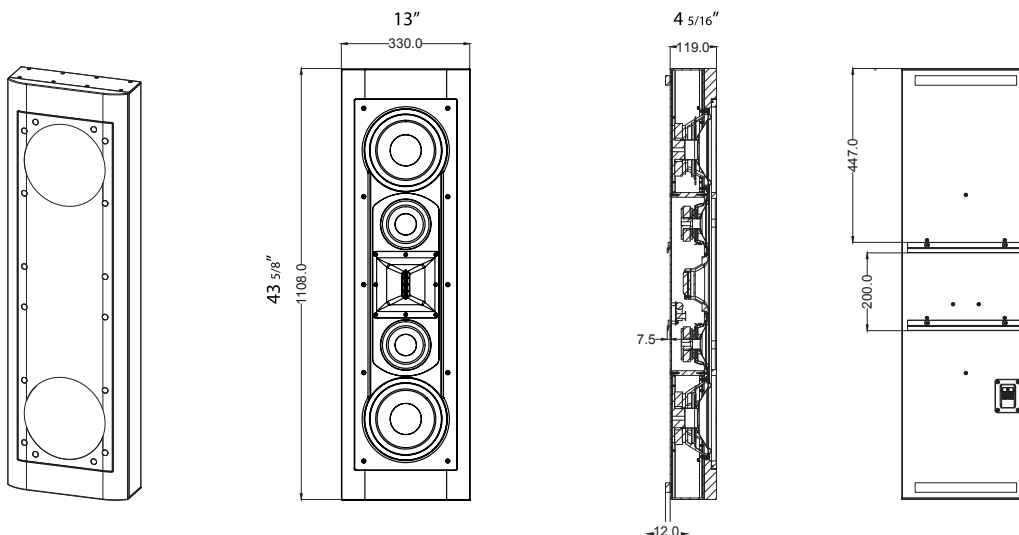

1B IN-WALL: AM5600IW

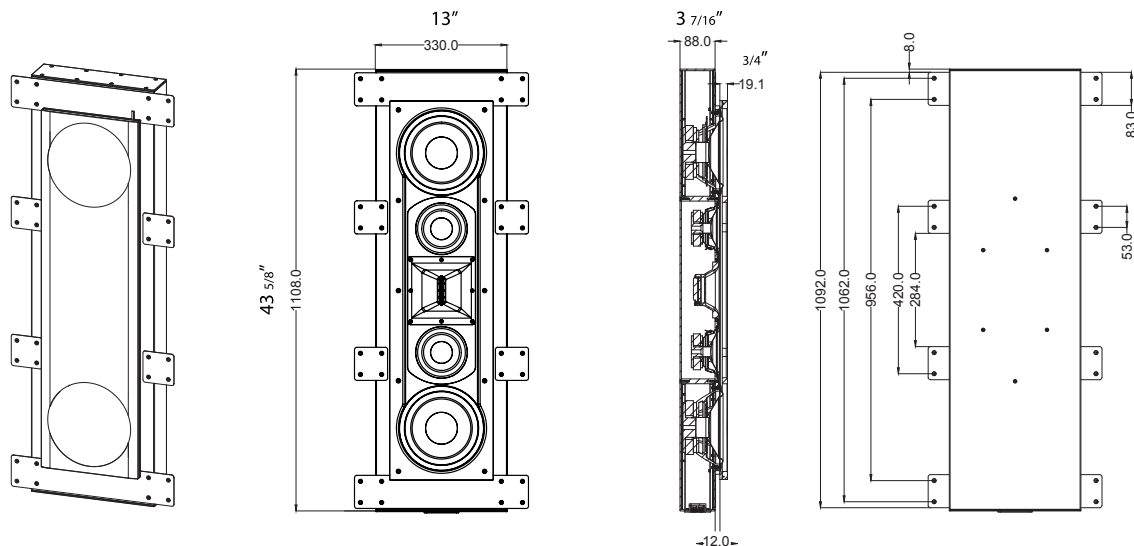

M

SPECIFICATION DETAILS

2 SURROUND SPEAKERS

- **Frequency Response:** 45Hz-20KHz (-10dB), 70Hz-20kHz (-3dB)
- **Maximum SPL @ 1m:** 115dB Continuous Program / 118dB Peak
- **System Coverage:** 100 degree Horizontal, 60 degree Vertical
- **Sensitivity, 2.83v/1m:** 92 dB
- **Recommended Amp:** Origin Pro Amplifiers
- **Rated Impedance:** 4 ohms
- **OW Dimensions:** 21 9/16" H x 13"W x 4 11/16"D (548 mm H x 330 mm W x 119 mm D)
- **IW Dimensions:** 21 9/16" H x 13"W x 3 7/16" D (3 7/16" Cabinet / 3/4" Wall Faceplate)
(548 mm H x 330 mm W x 88 mm D) (88 mm Cabinet / 20 mm Wall Faceplate)

2A ON-WALL: AM3600OW

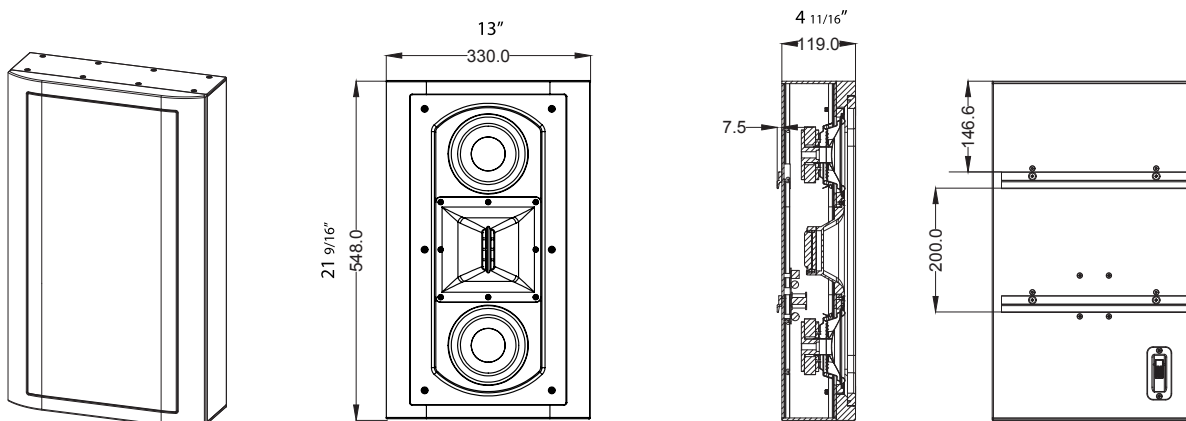

2B IN-WALL: AM3600IW

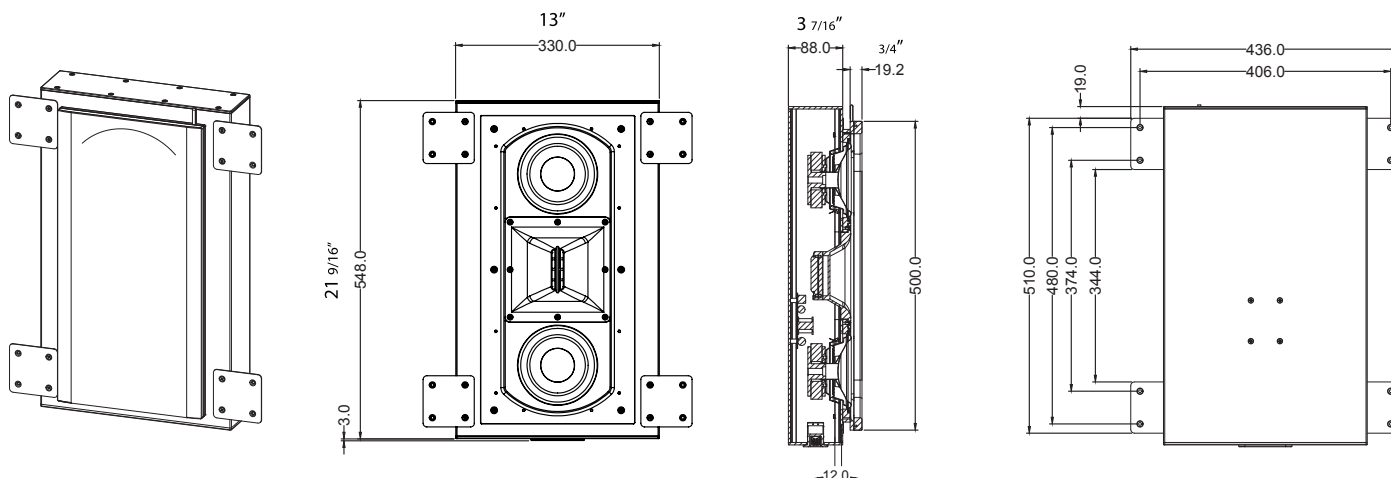

M

SPECIFICATION DETAILS

3 DUAL 10" SUBWOOFERS

- **Frequency Response:** 22Hz-200 Hz (-10dB), 29Hz-200Hz (-3dB)
- **Maximum SPL @ 1m:** 116dB Continuous Program / 122dB Peak
- **System Coverage:** 100 degree Horizontal, 60 degree Vertical
- **Sensitivity, 2.83v/1m:** 90dB
- **Recommended Amp:** Origin Pro Amplifiers
- **Rated Impedance:** 4 ohms
- **OW Dimensions:** 34 5/8" H x 13"W x 4 11/16" D (800 mm H x 330 mm W x 119 mm D)
- **IW Dimensions:** 34 5/8" H x 13"W x 3 7/16" D (3 7/16" Cabinet / 3/4" Wall Faceplate)
(800 mm H x 330 mm W x 88 mm D) (88 mm Cabinet / 20 mm Wall Faceplate)

3A ON-WALL: AMD10OWSUB

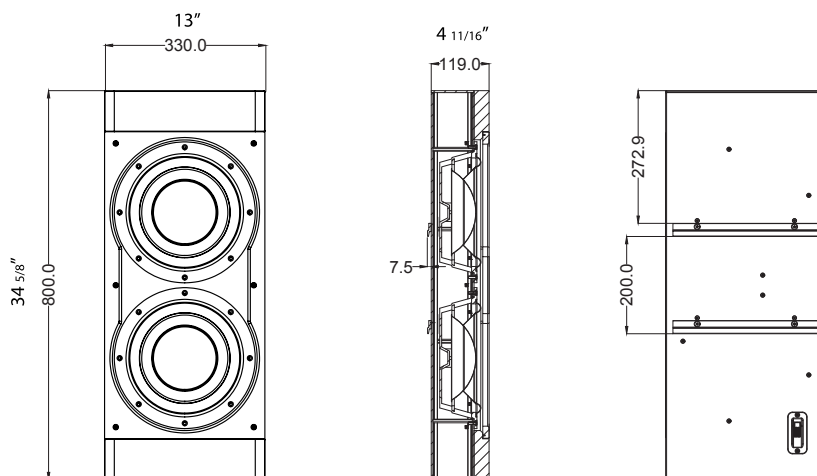
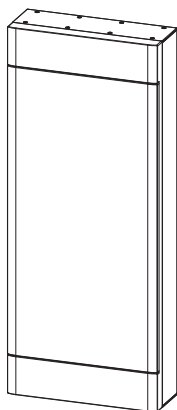

3B IN-WALL: AMD10IWSUB

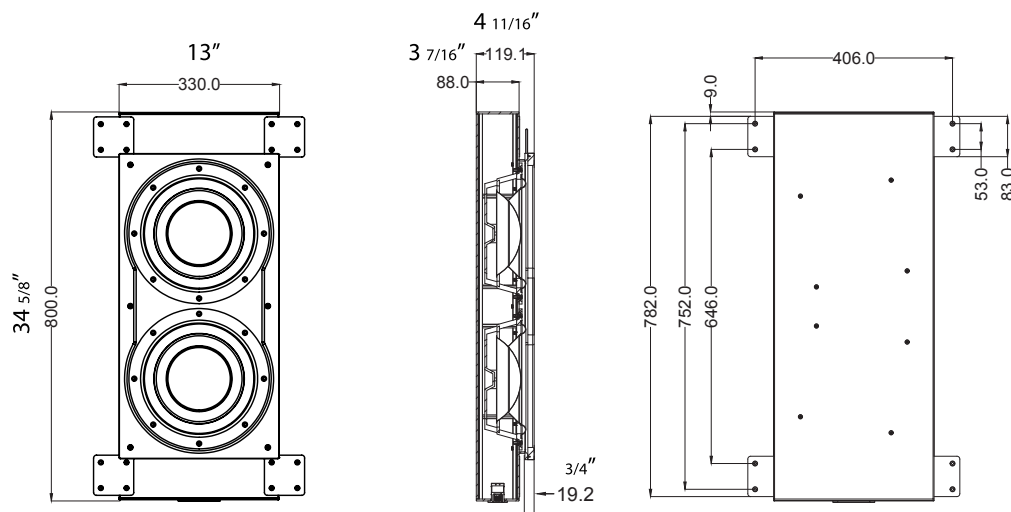
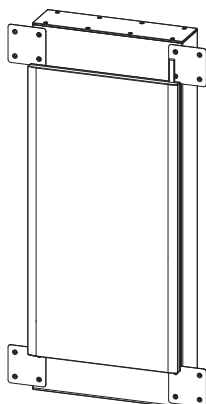



SPECIFICATION DETAILS

4 IN-CEILING SPEAKERS

- **Frequency Response:** 70Hz-20KHz
- **Power Handling:** 50W AES Noise • 100W Program • 150W Peak
- **Recommended Amp:** Origin Pro Amplifiers
- **Rated Impedance:** 4 ohms
- **Diameter:** 11 ¼" (286 mm)
- **Grille Diameter:** 11 ¾" (298 mm)
- **Cut-Out Diameter:** 10 ⅜" (264 mm)
- **Mounting Depth:** 6 ¼" (158 mm)

IN-CEILING: M2500IC

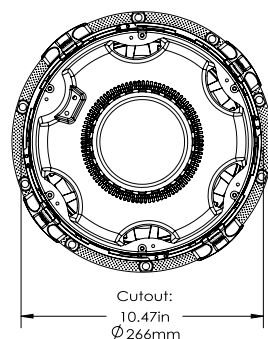
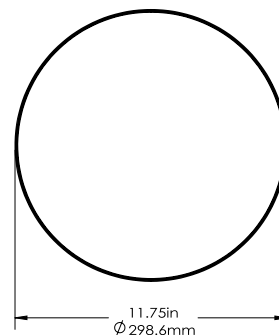
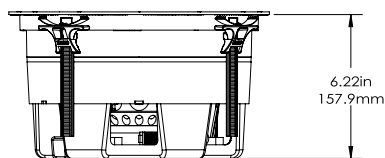
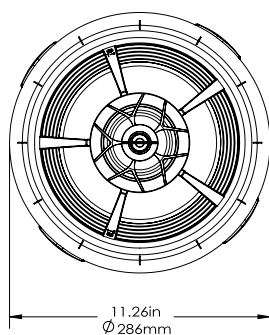
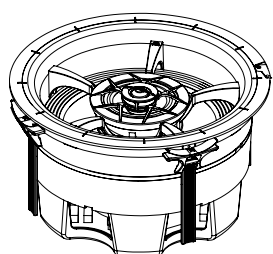

*All product information is subject to change. Please refer to docs.originacoustics.com for additional resources.