



SCAN QR CODE FOR FULL INSTALLATION MANUAL



THESE IN-WALL SPEAKERS ARE DESIGNED FOR NEW CONSTRUCTION INSTALLATIONS, ONLY TO BE INSTALLED BEFORE DRYWALL INSTALLATION.

WHAT'S INCLUDED

• ALL MODELS

- Grille (1pc)
- Baffle (1pc)
- Wood Protection Cover (1pc)

• AM5600IW

- Long Mounting Brackets (2pcs)
- Short Mounting Brackets (4pcs)
- Mount Screws - M4 x 8mm (16pcs)
- Baffle Screws - M6 x 35mm (10pcs)
- 1" Wall Stud Screws (16pcs)

• AM3600IW

- Short Mounting Brackets (4pcs)
- Mount Screws - M4 x 8mm (8pcs)
- Baffle Screws - M6 x 35mm (6pcs)
- 1" Wall Stud Screws (8pcs)

• AMD10IWSUB

- Short Mounting Brackets (4pcs)
- Mount Screws - M4 x 8mm (8pcs)
- Baffle Screws - M6 x 35mm (6pcs)
- 1" Wall Stud Screws (8pcs)

INSTALLATION OF AM5600IW, AM3600IW, & AMD10IWSUB IN-WALL SPEAKERS

- Decide the location of the speaker to be mounted on the wall.
- The front LCR and surround speakers should be ideally mounted at the listener's ear height when seated for the best sound experience.
- The speakers should be mounted according to your home theater design configuration.

The speaker arrives with a wooden protection cover screwed onto the face of the speaker. Remember:

THE WOODEN PROTECTION COVER SHOULD NOT BE REMOVED UNTIL FINAL STEP OF BAFFLE ATTACHMENT.

INSTALLATION OF WIRE TO THE AMPLIFIER

- Strip $\frac{3}{16}$ inches (5 mm) of the insulation off both ends of the wire.
- To avoid stray strands, twist them at the end.
- Connect the speaker wire to the amplifier, but don't plug in the AC power just yet.
- Route this wire to the speaker location. Continue speaker wiring in the following step.

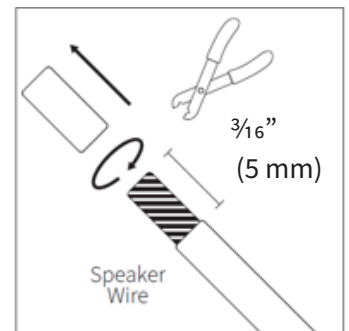

INSTALLATION OF WIRE TO THE SPEAKER

Depending on how you ran the wires to the speaker location, the wires can be attached to the connectors at one end of the enclosure.

- Route the wire and insert into the corresponding Phoenix connector on each speaker.
- Use a small flat head screwdriver to tighten the screw to secure the wire.
- ***Each LCR speaker uses 2 x 2PIN connectors and uses 4 x wire conductors.***
- ***Each Surround speaker /Subwoofer uses a singular 2PIN connector and use 2 x wire conductors.***
- ***Pay attention to speaker wire polarity, Positive (+) and Negative (-), when wiring to the amplifier speaker wires.***

INSERTING 2 PIN CONNECTIONS

AM5600IW

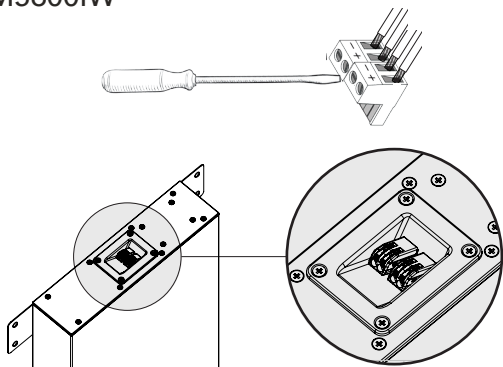

AM3600IW & AMD10IWSUB

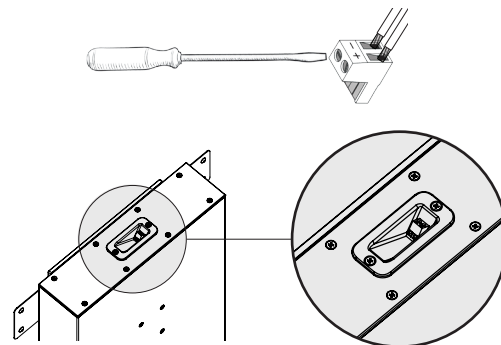

MOUNTING THE SPEAKERS

First secure each IW speaker into its mount brackets. Then secure the mounted speaker in brackets to the wall studs.

Then test each speaker.

- Use the **2 INNER SCREW HOLES (A)** on each mount bracket to secure the speaker to the bracket, using the M4 x 8mm screws.
- Use the **2 OUTER SCREW HOLES (B)** on each mount bracket to secure the bracket and speaker to the wall studs, using the 1" Wall Stud Screws.

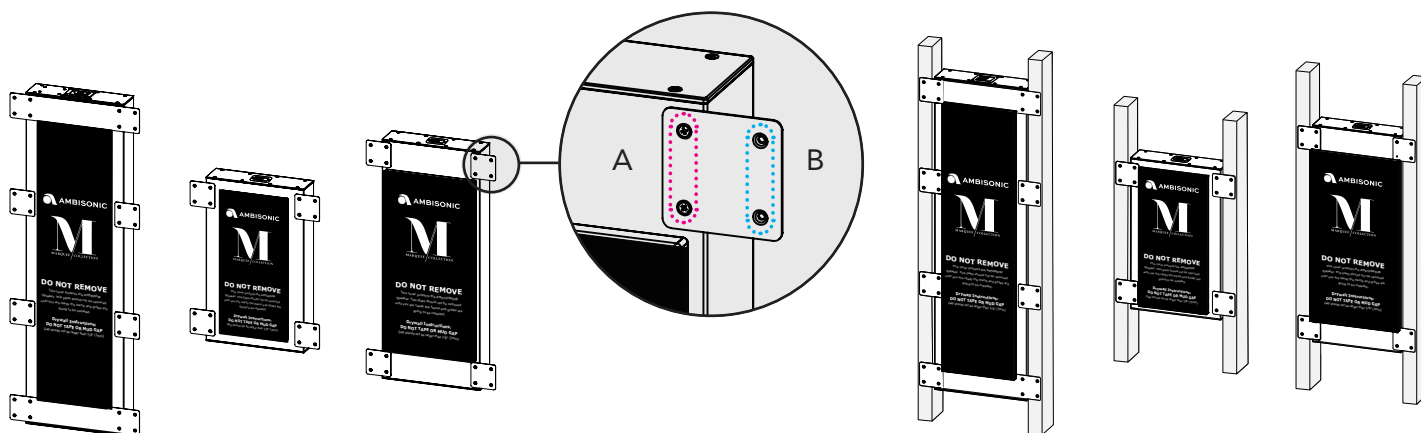

**WE RECOMMEND TESTING THE SYSTEM AT THIS TIME
TO ENSURE THE SPEAKER IS INSTALLED AND WORKING PROPERLY.**

**IMPORTANT: TAKE OFF THE PROTECTION COVER BY UNSCREWING THE 4 SCREWS TO
CONDUCT A SOUND TEST. REPLACE IT BEFORE THE DRYWALL STEP.**

INSTALLING DRYWALL OVER SPEAKER

1. MEASURE & TRANSFER PERIMETER

Once the drywall is ready to go up:

• **USE A TAPE MEASURE TO ACCURATELY MEASURE AROUND THE PERIMETER OF THE SPEAKER PROTECTION COVER, BY TAKING THE FOLLOWING 8 DIMENSIONS** to the **CORNERS OF THE WOODEN PROTECTION COVER** (SEE ILLUSTRATIONS 1 & 2):

4 X HORIZONTAL MEASUREMENTS:

- **H1 & H2:** Measure from:

LEFT EDGE OF DRYWALL to:

TOP LEFT CORNER OF WOODEN PROTECTION COVER.

BOTTOM LEFT CORNER OF WOODEN PROTECTION COVER.

- **H3 & H4:** Measure from:

LEFT EDGE OF DRYWALL to:

TOP RIGHT CORNER OF WOODEN PROTECTION COVER.

BOTTOM RIGHT CORNER OF WOODEN PROTECTION COVER.

4 X VERTICAL MEASUREMENTS:

- **V1 & V2:** Measure from:

BOTTOM EDGE OF FLOOR to:

LEFT BOTTOM CORNER OF WOODEN PROTECTION COVER.

RIGHT BOTTOM CORNER OF WOODEN PROTECTION COVER.

- **V3 & V4:** Measure from:

BOTTOM EDGE OF FLOOR to:

LEFT TOP CORNER OF WOODEN PROTECTION COVER.

RIGHT TOP CORNER OF WOODEN PROTECTION COVER.

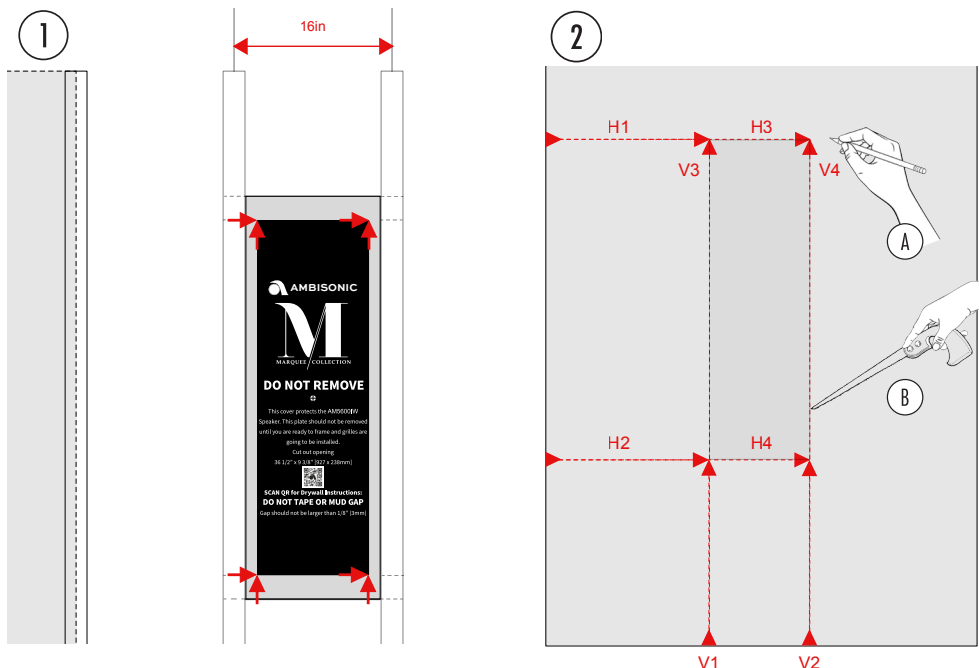

NOTE: For accuracy, it is recommended to transfer each measurement one by one, directly moving the tape measure to the drywall, each time as soon as each measurement is taken, to mark it on the drywall board.

NOTE: If you are going to use the back of the drywall to make the marks, pay attention to the edge that is making contact when you transfer your measurements

- Taking the 4 x Horizontal & 4 x Vertical Measurements from Step 1 (See Illustration 1), directly transfer them to the drywall sheet you are going to install (See Illustration 2: : H1/H2/H3/H4 & V1/ V2/V3/V4).

2. CUT OUT PERIMETER

- On the drywall, use your markings to draw out 2 x Vertical and 2 x Horizontal cut lines (See Illustration 2- A), to identify the rectangular cut out area. Insert a keyhole saw or use a router to cut along the perimeter of this cut out area (See Illustration 2-B).

THESE IN-WALL SPEAKERS ARE DESIGNED FOR NEW CONSTRUCTION INSTALLATIONS ONLY, TO BE INSTALLED BEFORE DRYWALL INSTALLATION.

3. FIT & SECURE DRYWALL

- Fit the drywall piece over speaker, and locate wall studs to secure the drywall around speaker perimeter.
- Insert the included 16 x Wall Stud Screws around the wood enclosure, as shown in Illustration 4.
- Use care not to hit the speaker mount brackets.

THE GAP BETWEEN PROTECTION COVER & DRYWALL SHOULD NOT BE LARGER THAN 1/8" (3MM).

TAKE CARE TO CUT DRYWALL TO THE EDGE OF THIS PROTECTION COVER. DO NOT TAPE OR MUD GAP.

- Now the drywall can be prepared/textured, and painted according to the required final room finish.

BAFFLE & GRILLE INSTALLATION

When ready to install the speaker baffle:

Start by removing the wooden protection cover.

- **By removing the protection cover:**

This will RELEASE 4 machine screws.

- **To insert the baffle into the enclosure:**

You will REUSE these 4 x M6 machine screws from the protection cover (A1/A2/A3/A4).

- **Now add the corresponding bagged M6 machine screws (See B1/B2/B3/B4/B5/B6 for each speaker in Illustration 5 below)**

(AM5600IW: 6 x bagged M6 machine screws & AM3600IW / AMD10IWSUB: 2 x bagged M6 machine screws)

- **This will result in the baffle using:**

AM5600IW:

Total of 10 x M6 screws for each Baffle

AM3600IW / AMD10IWSUB:

Total of 6 x M6 screws for each Baffle,
to be secured into the speaker enclosure.

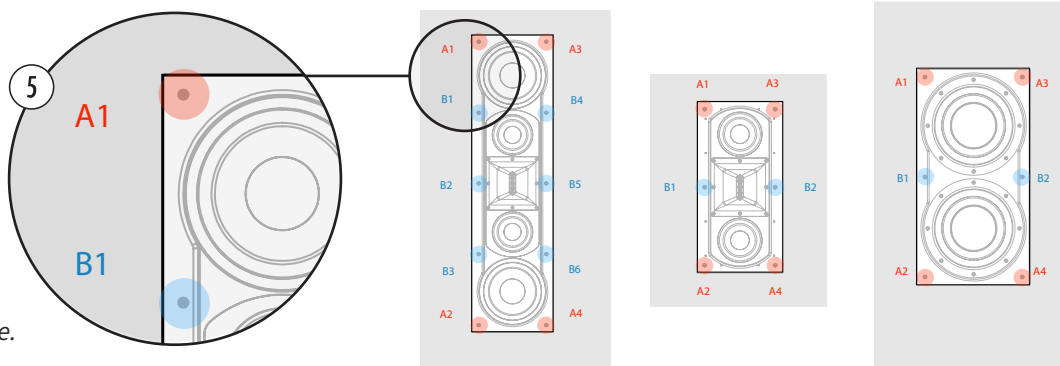
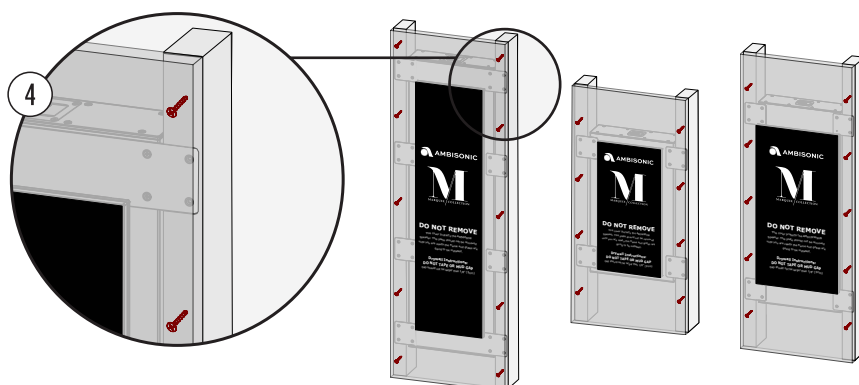

MOUNTING THE GRILLE

- Fit the grille over the speaker; the grille will be held securely by the magnets.

If you have any questions or concerns about installing or using this product, you can reach us for technical assistance.

Phone: (844) 674 - 4461 • Hours of operation: 8:00am - 5:00pm (Pacific Time), Mon - Fri • Email: sales@originacoustics.com