



AM5600OW • AM3600OW • AMD10OWSUB • AM650OWA

ON-WALL LCR SPEAKERS  
ON-WALL SURROUND SPEAKERS  
ON-WALL SUBWOOFERS  
ON-WALL ANGLED SURROUND SPEAKERS

*AMBISONIC MARQUEE HOME THEATER SYSTEM*  
**ON WALL INSTALLATION MANUAL**





## TABLE OF CONTENTS

1. Introduction	.....	1
2. Specifications	.....	2
3. Model Linedrawings	.....	4
4A. What's Included	.....	6
4B. Required Tools	.....	7
4C. Recommended Amplifiers	.....	7
5. System Design: Guidance & Precautions	.....	8
6. System Positioning Tips	.....	9
7. Speaker Wire Tips	.....	13
8. On-Wall Speaker Installation	.....	15
10. Connecting the System	.....	21
11. Testing the System	.....	22
13. Troubleshooting	.....	23
14. Technical Assistance	.....	24
15. Limited 5 Year Warranty	.....	25
16. Return Process	.....	26

# 1. INTRODUCTION

Congratulations on selecting the Ambisonic Marquee Home Theater System: Ambisonic Systems' first dedicated High-Performance Planar Ribbon Home Theater System.

At Ambisonic, we take pride in providing you with a high quality product, all speakers are designed to have excellent sound quality, longevity, and a simple installation process.

Ambisonic Systems has delivered high performance experiences in luxury outdoor settings for decades. Now, our new Ambisonic Marquee home theater system features the same proprietary technologies and quality materials into dedicated home theaters.

This instruction booklet covers the necessary information for a smooth installation. It includes the tool list you will need, step-by-step instructions for installation, troubleshooting tips for any errors that may occur, and all warranty information.

If for any reason you experience problems or if you have installation questions please call us at (844) 674-4461. Hours of operation are 8:00am to 5:00pm (Pacific Time), Monday through Friday.

*Scan the QR Code for full instructions for this product.*



## 2. SPECIFICATIONS

MODEL	AM5600IW (In-Wall) • AM5600OW (On-Wall)
DESCRIPTION	<i>Front of House LCR Speakers (bi-amped)</i>
System Type	Three-way full range, screen or music
Tweeter	3" Magnetic Planar Ribbon Tweeter with Exclusive Waveguide
Midrange	2 x 5 1/4" Woven Fiberglass Mid-Woofers
Woofers	2 x 8" Woven Fiberglass Woofers
Crossover	DSP Bi-Amp LF, passive mid-hi custom 2 way
Frequency Response	32Hz-20KHz (-10dB) • 43Hz-20KHz (-3dB) • 49Hz-20KHz (+/- 1.5dB)
Maximum SPL @ 1m	120 dB Continuous Program • 123 dB Peak
System Coverage	100° Horizontal • 60° Vertical
Sensitivity, 1W/1m	94 dB
Power Handling	LF = 200W AES noise • 400W program • 800W peak. MH = 100W AES noise • 200W program • 400W peak
Recommended Amp Power	LF-200W - 800W @ 4 ohms MH-100 - 400W @ 4ohms
Rated Impedance	4 ohms
Enclosure Material	Extruded Aluminum Enclosure
OW Dimensions	43 5/8" H x 13" W (1108 mm H x 330 mm W)
OW Depth	4 5/16" D (119 mm D)

MODEL	AM3600IW (In-Wall) • AM3600OW (On-Wall)
DESCRIPTION	<i>Surround Speakers</i>
System Type	Two-way full range, surround, screen or music
Tweeter	3" Magnetic Planar Ribbon Tweeter with Exclusive Waveguide
Mid-Woofers	2 x 5 1/4" D (88 D mm)" Woven Fiberglass Mid-Woofers
Crossover	Passive custom 2 way
Frequency Response	45Hz-20KHz (-10dB) • 70Hz-20KHz (-3dB) • 81Hz-20KHz (+/- 1.5dB)
Maximum SPL @ 1m	115 dB Continuous Program • 118 dB Peak
System Coverage	100° Horizontal • 60° Vertical
Sensitivity, 1W/1m	92 dB
Power Handling	100W AES noise • 200W program • 400W peak
Recommended Amp Power	100 - 400W @ 4ohms
Rated Impedance	4 ohms
Enclosure Material	Extruded Aluminum Enclosure
OW Dimensions	21 9/16" H x 13" W (548 mm H x 330 mm W)
OW Depth	4 5/16" D (119 mm D)

MODEL	AMD10IWSUB (In-Wall) • AMD10WSUB (On-Wall)
DESCRIPTION	<i>Subwoofer</i>
System Type	Subwoofer, screen or music
Subwoofer	Dual 10" Aluminum Cone Long Throw Woofers
Crossover	Recommended HPF=20Hz 12dB/oct BW • LPF= 80hz 12dB/oct BW
Frequency Response	22Hz-200Hz (-10dB) • 29Hz-200Hz (-3dB) • 33Hz-116Hz (+/- 1.5dB) (w/ recommended DSP)
Maximum SPL @ 1m	116 dB Continuous Program • 122 dB Peak
System Coverage	100° Horizontal • 60° Vertical
Sensitivity, 1W/1m	90 dB
Power Handling	500W AES noise • 1000W program • 2000W peak
Rated Impedance	4 ohms
Enclosure Material	Extruded Aluminum Enclosure
OW Dimensions	34 5/8" H x 13" W (800 mm H x 330 mm W)
OW Depth	4 5/16" D (119 mm D)

MODEL	M650OWA (On-Wall)
DESCRIPTION	<i>On-Wall Surround Speakers</i>
Tweeter	1 1/2" (38mm) Circular Planar Ribbon Driver
Woofer	6 1/2" (165mm) Paper/Kevlar Composite Woofer
Frequency Response	54Hz-20KHz (-10dB) • 64Hz-20KHz (+/-3dB)
Maximum SPL @1m	114dB Continuous Program / 117 dB Peak
Sensitivity, 1W/1m	91dB
Power Handling	75W AES Noise • 150W Program • 300W Peak
Rated Impedance	8 ohms
Enclosure Material	MDF Enclosure with Down-Angled Baffle
OW Dimensions	13 1/16" H x 9 13/16" W (347 mm H x 250 mm W)
OW Depth	8" D (202 mm D)

\*All product specifications are subject to change. Please refer to [ambisonicsystems.com](http://ambisonicsystems.com) for latest information.

### 3. MODEL LINEDRAWINGS

#### • AM5600OW

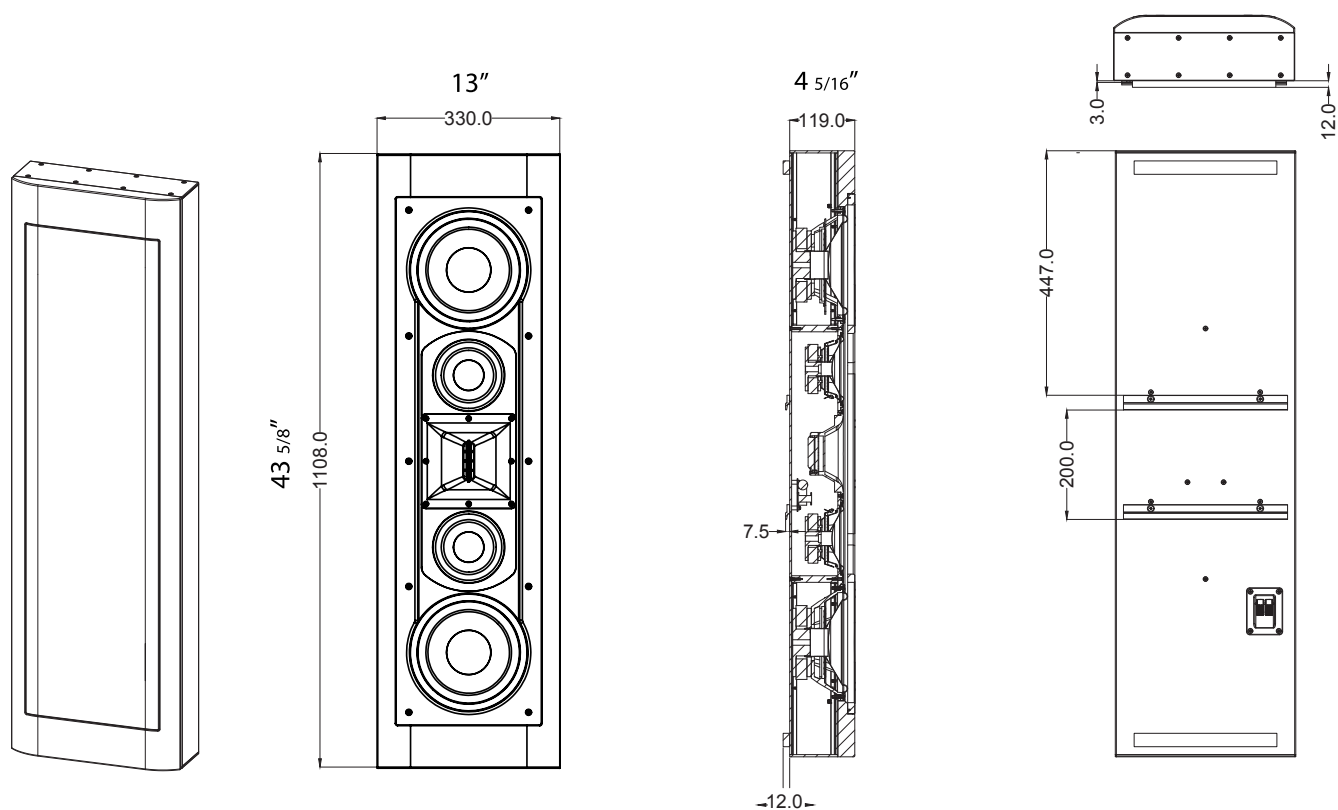

#### • AM3600OW

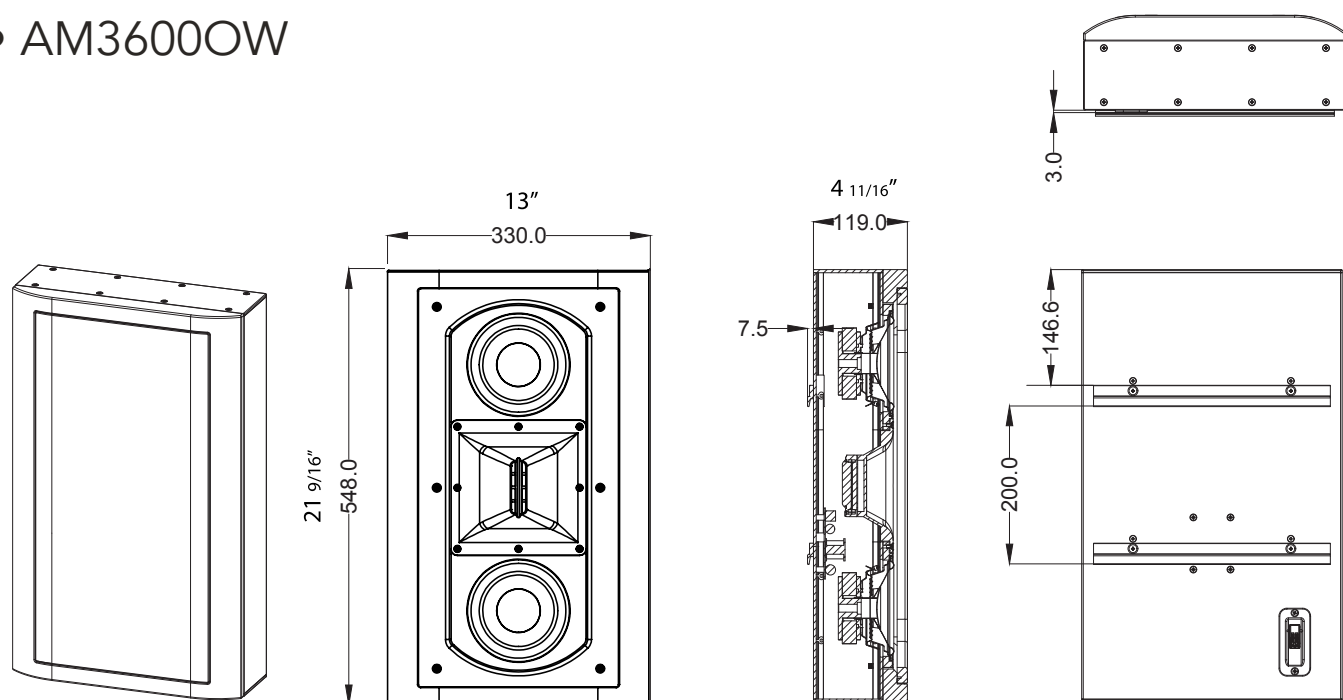

## • AMD10OWSUB

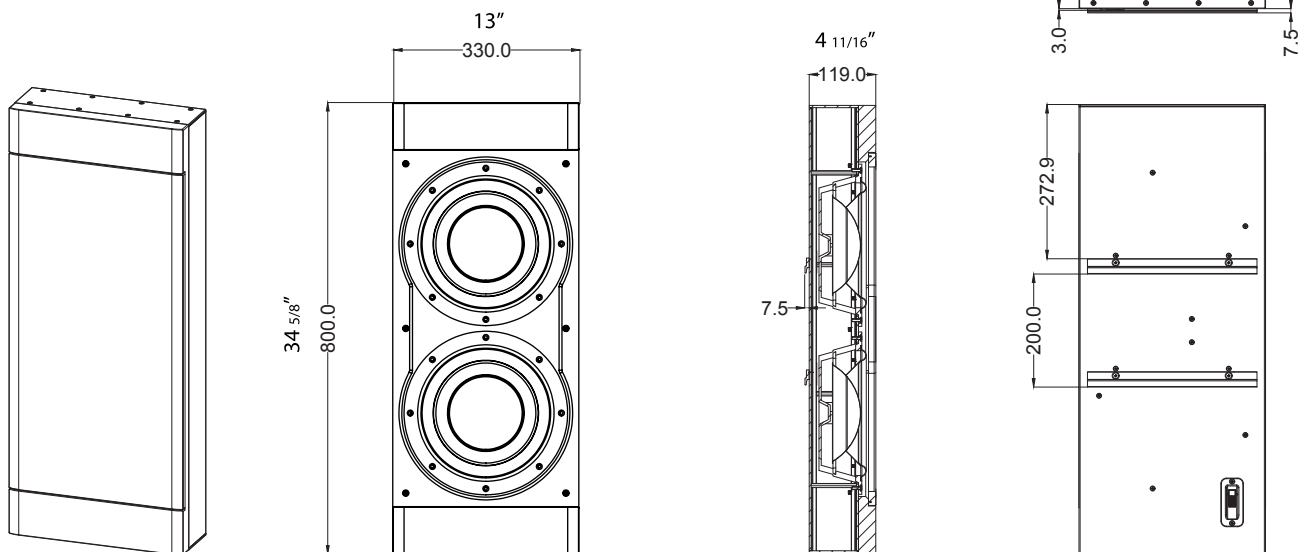

## • AM650OWA

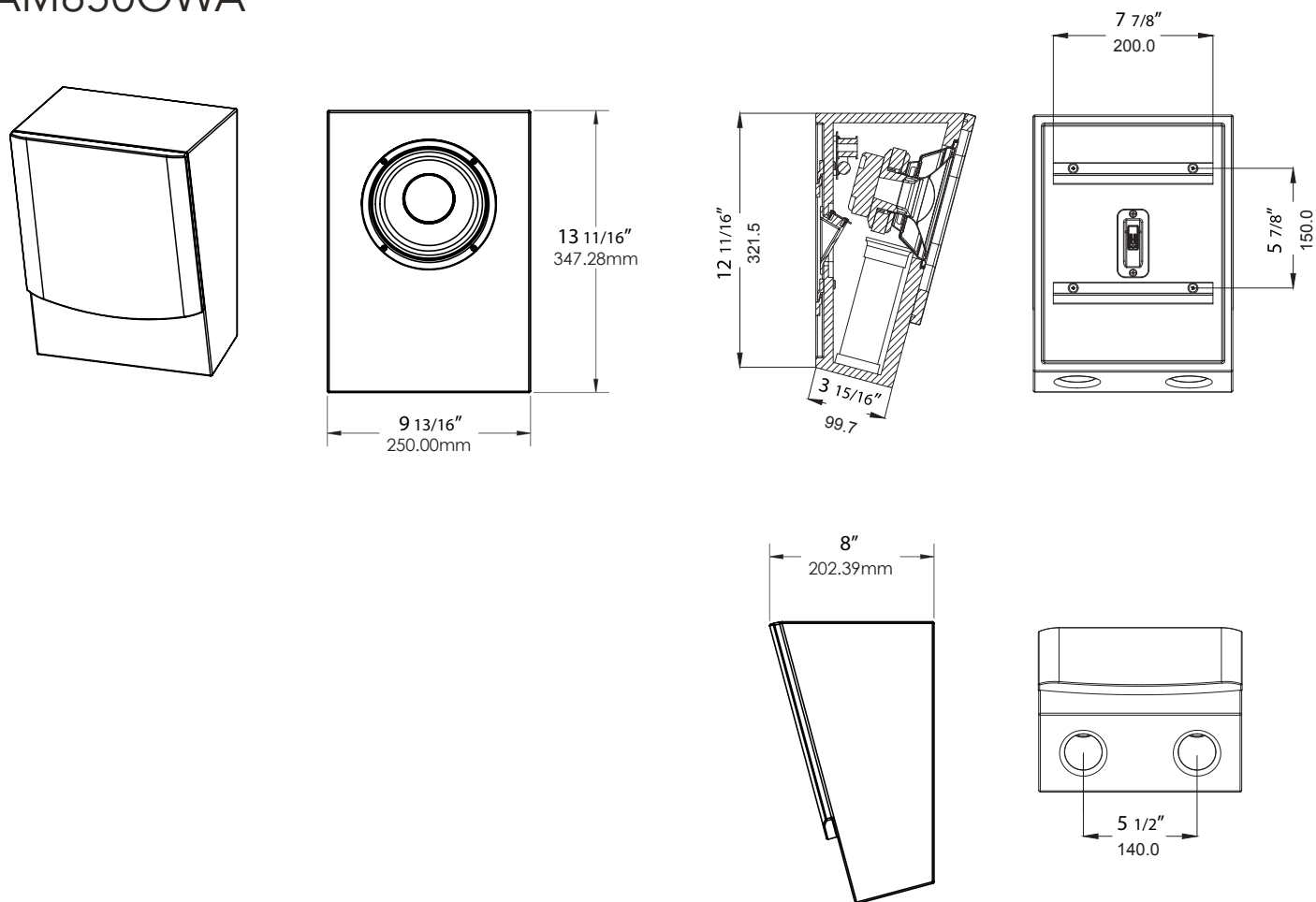

## 4A. WHAT'S INCLUDED

- AM5600OW
  - Wall Mounting Brackets (1pc)
  - Wall Bracket Screws (4pcs)
  - Hole Mounting Template (1pc)
  - Grille (1pc)
  - Wall Anchors (4pcs)
  - Quick Start Guide

- AM3600OW
  - Wall Mounting Brackets (1pc)
  - Wall Bracket Screws (4pcs)
  - Hole Mounting Template (1pc)
  - Grille (1pc)
  - Wall Anchors (4pcs)
  - Quick Start Guide

- AMD10OWSUB
  - Wall Mounting Brackets (1pc)
  - Wall Bracket Screws (4pcs)
  - Hole Mounting Template (1pc)
  - Grille (1pc)
  - Wall Anchors (4pcs)
  - Quick Start Guide

- AM650OW
  - Wall Mounting Brackets (2pcs)
  - Wall Bracket Screws (4pcs)
  - Hole Mounting Template (1pc)
  - Grille (1pc)
  - Wall Anchors (4pcs)
  - Quick Start Guide



## 4B. REQUIRED TOOLS

- Speaker Wire
- Drywall Saw
- Stud Finder
- Pencil
- Drill & Drill Bit 1/8" (3mm)
- Level
- Wire Stripper
- Hex wrench
- Fish Tape
- Measuring Tape
- Stiff Wire
- Compressed Air

## 4C. RECOMMENDED AMPLIFIERS

- **THE RECOMMENDED AMBISONIC MARQUEE SPEAKER BUNDLES WITH THE ORIGIN PRO AMPLIFIERS HAVE BEEN BUILT TO OPTIMIZE SPEAKER AUDIO PERFORMANCE.**
- The minimum recommended amplifier for an AM3600 speaker system setup is the **Origin PRO ProA250.1 Amplifier**
- The minimum recommended amplifier for an AM5600 LCR speaker system setup is the **Origin PRO ProA1200.2 Amplifier**
- The minimum recommended amplifier for an AMD10SUB Subwoofer speaker system setup is the **Origin PRO ProA1000.1 Amplifier**
- The minimum recommended amplifier for an AM650OWA speaker system setup is the **Origin PRO ProA250.1 Amplifier**

## 5A. SYSTEM DESIGN GUIDANCE

The final result of a quality home theater is more than simply the sum of its components. Great care must be taken to integrate it aesthetically and acoustically into the space. The dimensions of the room and the seating position will determine the geometry of the speaker placement so as to create the proper sound-stage both horizontally and vertically.

Ideally, the tweeter of the front LCR speakers will be at ear level whereas the side and rear channels can be anywhere from slightly above the listener to in the ceiling itself. If you are laying out a Dolby Atmos® system, the side and rear channel speakers should be in or on the walls while the height channels would be in the ceiling to create the proper “over-head” effect.

Subwoofer locations are critical as nodes and lobes can dramatically affect the amount of bass experienced at the listening position. Regardless of the size of the woofer or the amount of power, bass waves can cancel each other and leave you with little or no perceived bass. One suggestion is to place the subwoofer at the listening positions and then walk the room in search of where the bass appears to be loudest. Placing the subwoofer in the loudest position will often result in substantial bass where you want it most. Dual subwoofers will typically limit this effect and allow for smoother overall bass response.

Quality electronics will also have a huge impact on the loudspeaker’s ability to accurately recreate the soundtrack. All amplification is not created equal, nor is all signal processing.

If you are not comfortable with making these decisions on your own, please consult a professional A/V integrator, or email [sales@originacoustics.com](mailto:sales@originacoustics.com) for more information.

## 5B. SYSTEM DESIGN PRECAUTIONS

- **THE SPEAKERS SHOULD BE MOUNTED ACCORDING TO YOUR HOME THEATER DESIGN CONFIGURATION. PLEASE REFER TO YOUR THEATER DESIGN FOR OPTIMAL HEIGHTS, DISTANCES, AND CONFIGURATION REQUIREMENTS.**
- **FOR OPTIMAL SETTINGS, USE THE RECOMMENDED THEATER DESIGN DSP PROFILE FOR THE ORIGIN PRO AMPLIFIER BEING USED.**

## 6. SYSTEM POSITIONING TIPS

For the best possible surround sound, all the speakers (except the subwoofer) should be placed at the same distance from the listening position.

*1. The illustration below shows an example of positioning a 9.2.6 system, as reference. (The images in this illustration differ from the actual units for explanation purposes.)*

**The 9.2.6 indicates the following:**

**9 - This number represents the number of traditional speakers (front, center, surround, etc.)**

**2 - This number represents the number of subwoofers you can connect to your receiver**

**6 - This number represent the number of overhead or Dolby Atmos enabled speakers you can use in this setup**

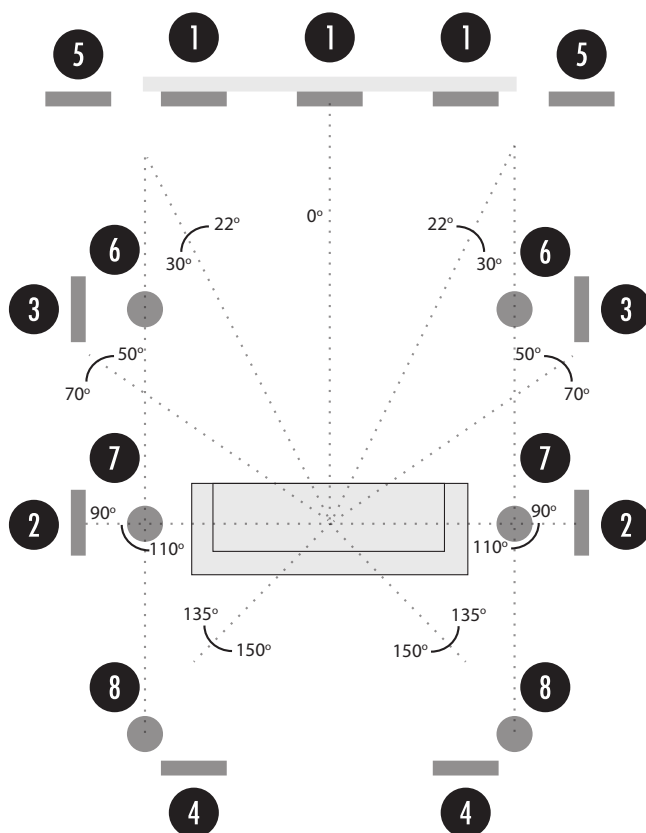

1- Left, Center & Right Speakers (3 pcs)

2- Side Surround Speakers (2 pcs)

3- Front Surround Speakers (2 pcs)

4- Back Surround Speakers (2 pcs)

5- Subwoofers (2 pcs)

6- Front Overhead Speakers (2 pcs)

7- Middle Overhead Speakers (2 pcs)

8- Rear Overhead Speakers (2 pcs)

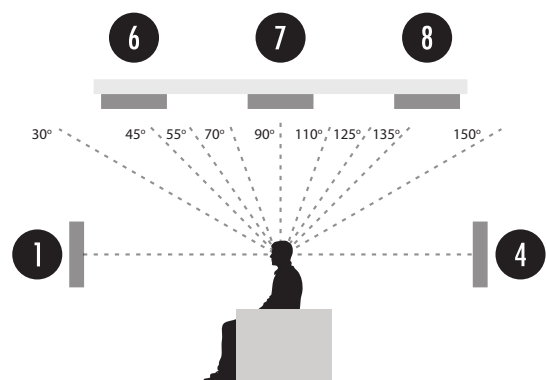

2. The illustration below shows an example of positioning a 7.2.6 system, as reference. (The images in this illustration differ from the actual units for explanation purposes.)

**The 9.2.6 indicates the following:**

**7 - This number represents the number of traditional speakers (front, center, surround, etc.)**

**2 - This number represents the number of subwoofers you can connect to your receiver**

**6 - This number represent the number of overhead or Dolby Atmos enabled speakers you can use in this setup**

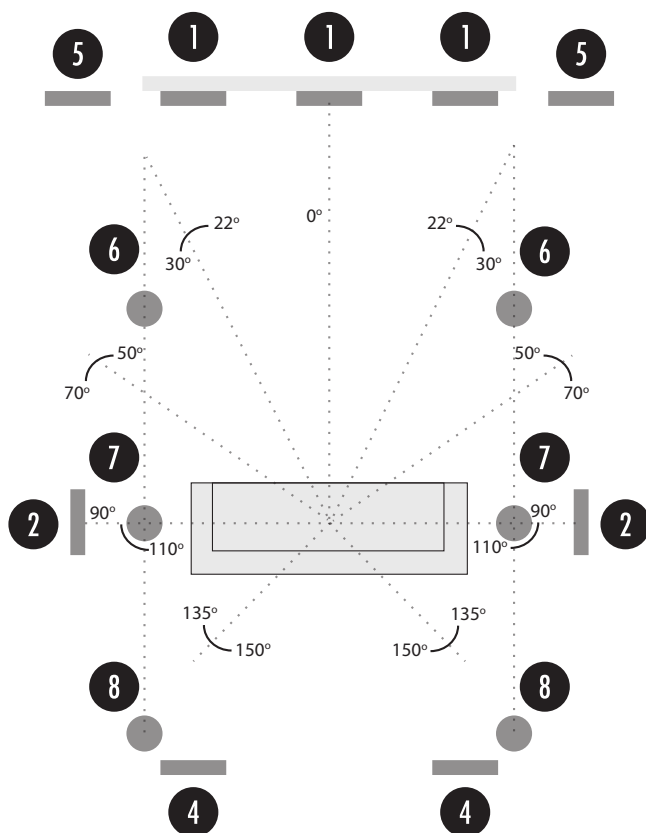

1- Left, Center & Right Speakers (3 pcs)

2- Side Surround Speakers (2 pcs)

3. X (Front Surrounds not used)

4- Back Surround Speakers (2 pcs)

5- Subwoofers (2 pcs)

6- Front Overhead Speakers (2 pcs)

7- Middle Overhead Speakers (2 pcs)

8- Rear Overhead Speakers (2 pcs)

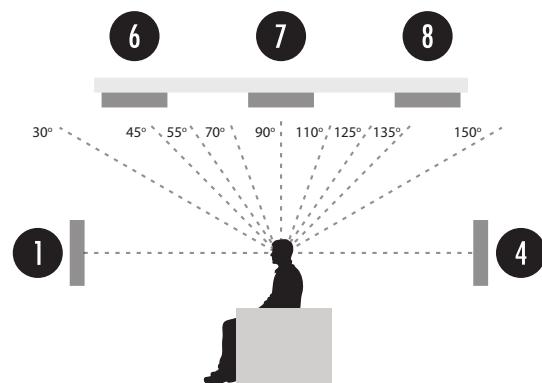

**Your system may have a different configuration (e.g. 5.1.2) depending on the number of speakers you plan to set up in the room.**

## 6A. Speaker Height Rule of Thumb

- The ideal position of the front LCR and surround speakers will be so that the center height of the speaker is level/equal with the listener's ears, for the best sound experience. This is because the exclusive Ambisonic wave guide is centered on each speaker, and this alignment will allow for the optimal listening experience.

## 6B. Front LCR Speaker Positions

### 1. Front Right / Left Speakers (Center speakers using acoustic transparent projection screen)

- Place the front speakers to the sides of the monitor or screen and as flush with the screen surface as possible.
- *The ideal position of the Front/LCR and Surround Speakers should be so that the center height of the speaker is level/equal with the listener's ears. This alignment will allow for the optimal listening experience, as because the exclusive wave guide is centered on each speaker. Bear in mind, the average sitting height is 42".*

**ALWAYS FOLLOW YOUR HOME THEATER DESIGN BLUE PRINTS.**

### 2. Front Center Speaker (For LCD, LED, OLED, etc)

- Place the center speaker above or below the monitor or screen so that the center channel's sound is localized.

## 6C. Surround Speaker Positions

### 3. Surround Right / Left Speakers

- *The surround speakers may be mounted to the left and right of the listener just above the head level.*

Place these speakers in line or slightly behind your listening position by about 10° to 20°.

### 4. Surround Rear Right / Left Speakers

- Place these speakers behind your listening position on right and left sides.

## 6D. Subwoofer Positions

### 5. Subwoofer(s)

- Always follow your home theater design blue prints. The basic rule of thumb is to place the subwoofer at the front, near to the Left or Right speakers, and place on the corresponding side to the wall (corner).

- *If not indicated in your home theater design blue print, leave 12 inches as a minimal clearance distance between the floor and the bottom of the subwoofer.*

## 7A. SPEAKER WIRE TIPS

You will need a wire that has at least two conductors; one that can be identified as the positive and the other as the negative. All two conductor wires have some means of identifying which conductor is which, but at times this identification may be subtle. It's crucial that you keep track of which wire you use for positive (+) and negative (-). Typically, if the wires are colored red and black, the red wire is used for positive and the black wire is used for negative, but sometimes other colors or patterns are used. You can choose whichever color of wire you want to be positive and negative as long as you remain consistent throughout the install.

On both your amplifier and your speaker, the connectors will be identified as red for positive and black for negative. It is very important to look carefully at the speaker wires and be certain that the same wire that is attached to the positive connector in the amplifier is attached to the positive connector in the speaker. If the negative and positive wires are switched, speaker performance will be drastically impacted.

## 7B. RECOMMENDED WIRE

### WIRE INSTALLATION

Wire Length	Wire Gauge
0 - 100' (0 - 30m)	16
50 - 150' (15 - 45m)	14
Over 100' (30m)	12

The gauge of wire used can have an impact on the performance of your speakers. Use a multi-stranded wiring designed for amplifier to speaker connections. Which gauge to select depends on the length of wire to be used on any particular speaker. The longer your run is, the larger your wire size must be.

## 7C. WIRE ROUTING

### Behind the Baseboard

The wire can be routed behind the baseboard by cutting a groove out of the back of the baseboard, or by buying special baseboard designed for concealing wires.

### Through Walls

When running wires through a wall, be sure to avoid all obstacles such as AC wiring, pipes, and ducts.

### Attic or Basement

When available, you can route the wire through an attic or crawlspace.

### Under the Carpet

One option is to lift the carpet and route “tape wire” under the carpet.

Plan how you’ll route the wire to the desired speaker location. There are several methods for routing the wire, and you may need to combine several of them.



## 8A. ON-WALL SPEAKER INSTALLATION

- Decide the location of the speaker to be mounted on the wall, referring to your home theater design configuration.
- The front LCR and surround speakers should be ideally mounted at the listener's ear height when seated for the best sound experience.

## 8B. INSTALLATION OF WIRE TO THE AMPLIFIER

- Strip  $\frac{3}{16}$  inches (5 mm) of the insulation off both ends of the wire.
- To avoid stray strands, twist them at the end.
- Connect the speaker wire to the amplifier, but don't plug in the AC power just yet.
- Route this wire to the speaker location. Continue speaker wiring in the following step.

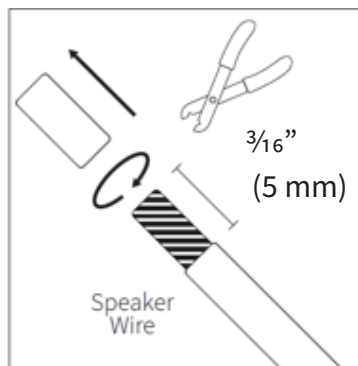

## Output Speaker Connection

### Examples:

#### AM3600 SPEAKER

CH1 = Left Speaker connection

CH 2 = Right Speaker connection

#### AM5600 SPEAKER

CH1= Mid-High Speaker connection

CH2= Woofer Speaker connection

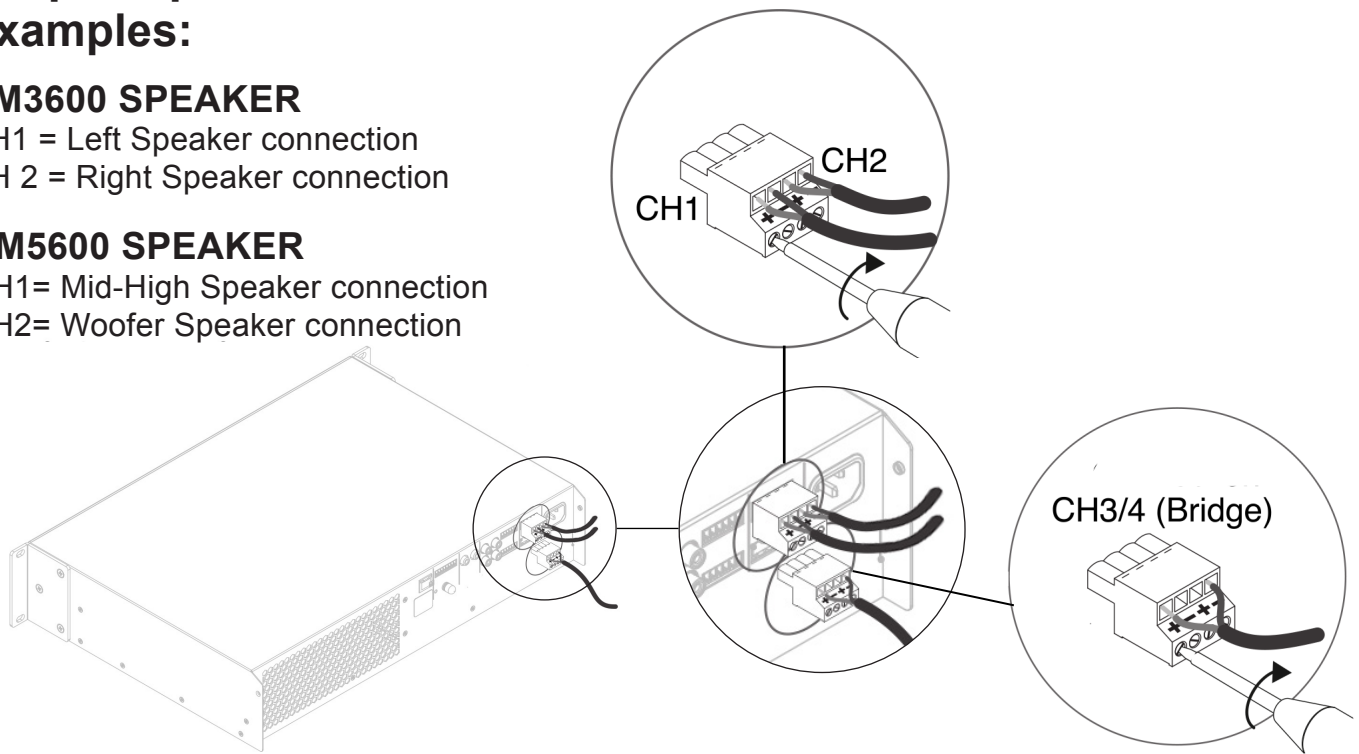

**Bridge Connection**  
for a 2U Origin ProA Series Amp

## 8C. ATTACHMENT OF WIRE TO THE SPEAKER

Depending on how you ran the wires to the speaker location, the wires can be attached to the connectors at one end of the enclosure.

- Route the wire and insert into the corresponding Phoenix connector on each speaker.
- Use a small flat head screwdriver to tighten the screw to secure the wire.

- ***Each LCR Speaker uses dual 2PIN connectors and requires 4 x wire conductors.***
- ***Each Surround Speaker/ Subwoofer uses a singular 2PIN connector and requires 2 wire conductors.***
- ***Pay attention to speaker wire polarity, Positive (+) and Negative (-), when wiring to the amplifier speaker wires.***

## 8D. INSERTING 2 PIN CONNECTIONS

- AM5600OW

Unit is Bi-Amplified: Check correct speaker wire connection between the Woofer speaker wire and the Mid-High speaker wire

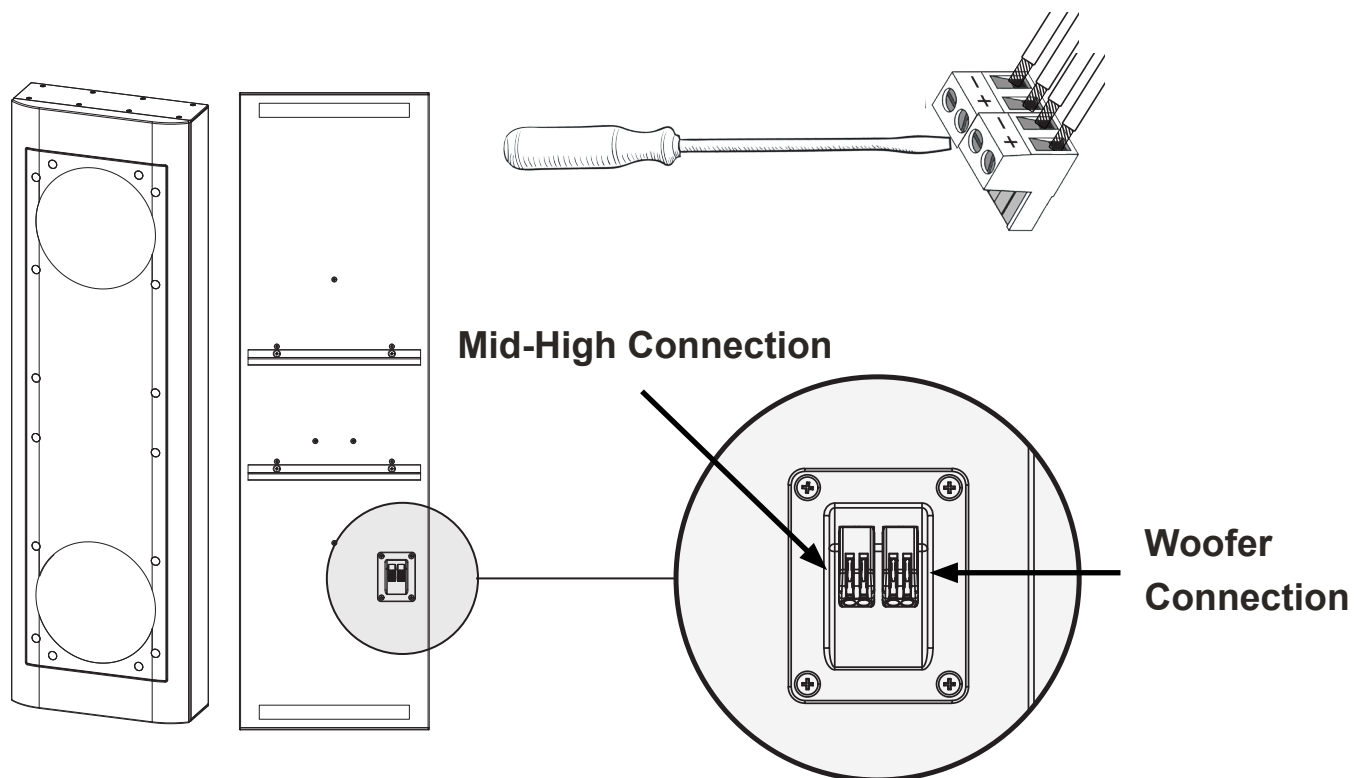

- AM3600OW & AMD10OWSUB

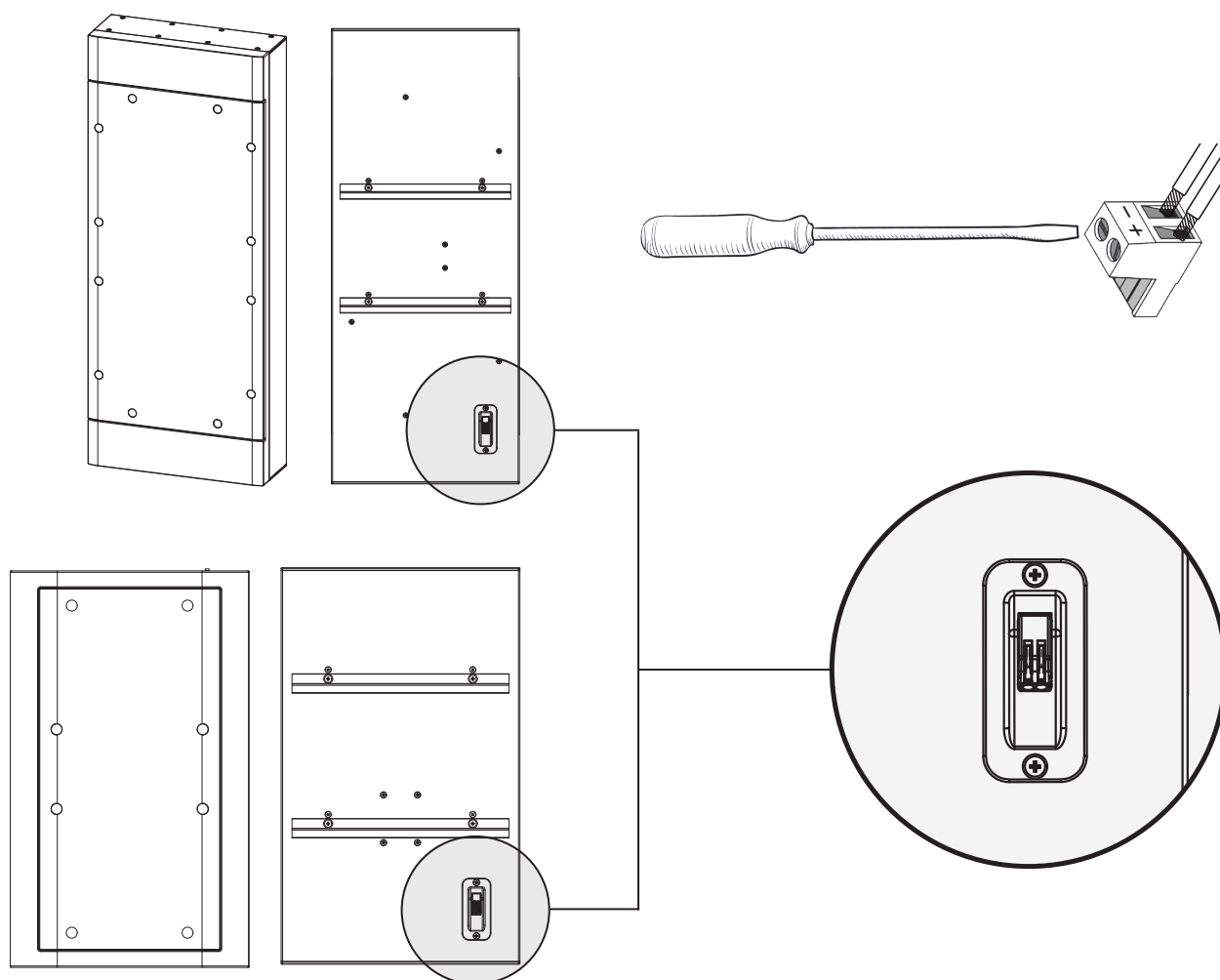

- AM6500OW

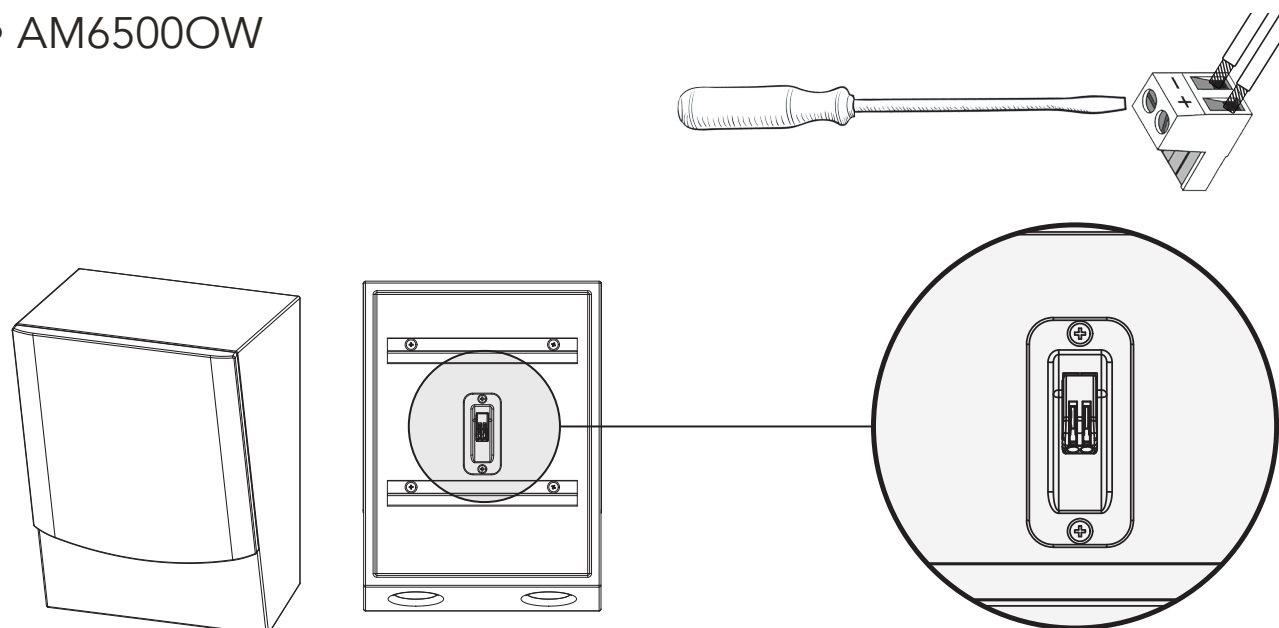

## 8E. MOUNTING THE ON-WALL SPEAKERS

First, use the provided Mounting Template to attach the wall bracket to the wall. Then you may hang the corresponding OW speaker off the bracket.

***Note: The AM3600/ AMD10OWSUB all share the same wall bracket model, while the AM650OWA Angled Surround uses its own set of double wall rails & mounting template.***

1. Locate the studs on the wall. (We highly recommend attaching the speaker wall bracket to a stud. If stud cannot be used, drywall anchors are recommended).
2. Reference your home theater system layout for each speaker placement.
3. Use a laser to identify tweeter height location, and then use the center “bullseye” marking on the Wall Bracket Mounting Template to align the central tweeter location on the wall.
4. Use a level to ensure the Mounting Template is aligned straight against the drywall.
5. Using a pencil, trace the holes on the template to mark them onto the wall.
6. Make pilot holes first, as necessary, depending on the surface you are mounting the speaker onto, and then secure the bracket on the wall using the supplied screws (and anchor screws for drywall mounting).
7. Once the bracket is secured, lift the speaker to connect the speaker wire accordingly. Then, use the mount rails on the back of the speaker, to hang the speaker onto the wall bracket. (The rails that align with the wall bracket are already attached to the speaker enclosure). Ensure that the speaker is properly secured into its position.

***8. Note: The wall bracket position remains the same for either a vertical vs horizontal mounting orientation.***

## 8F. AM5600OW, AM3600OW, & AMD10OWSUB TEMPLATE

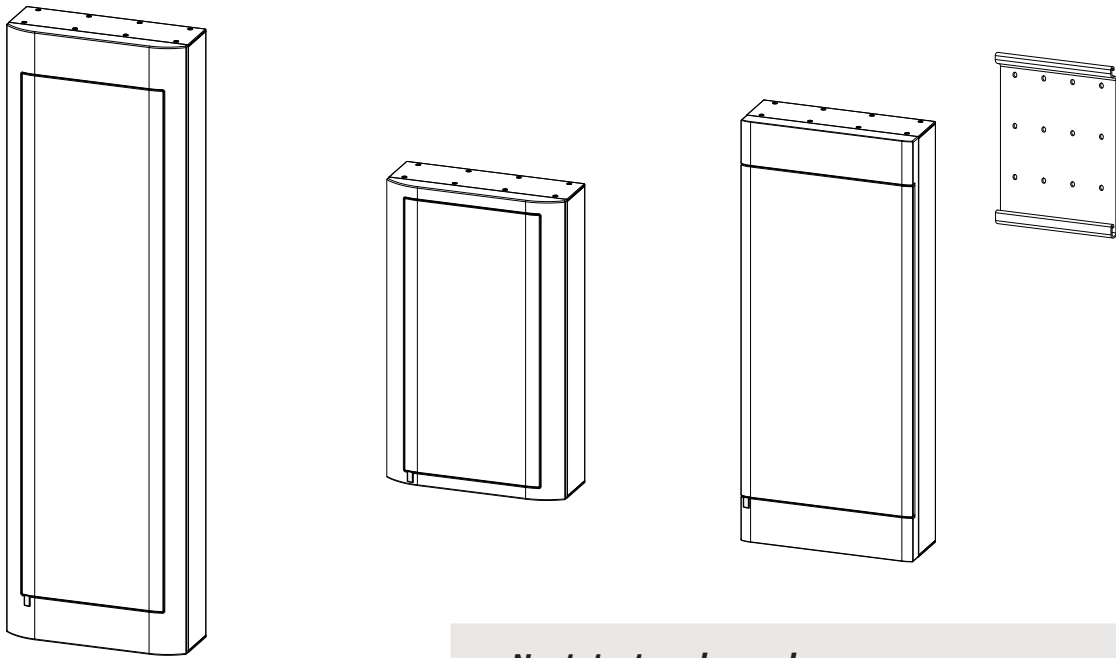

*Next, test each speaker.*

## 8G. TESTING THE MOUNTED SPEAKERS

**WE RECOMMEND TESTING THE SYSTEM AT THIS TIME TO ENSURE THE SPEAKER IS INSTALLED AND WORKING PROPERLY.**

**BE SURE TO CONDUCT A SOUND AND POLARITY TEST.**

## 8H. MOUNTING THE GRILLE

- Once the speakers are hung, you may fit the grille over the speaker; the grille will be held securely by the magnets.

## 9. CONNECTING THE SYSTEM

- Depending on your TV and other equipment you wish to connect, there are various ways you could connect the system.
- Please refer to the manuals of your TV, AV source player, or other devices as necessary to make the best connections.
- Make sure the source player is connected directly to the TV. Tune the TV to the correct video input channel.
- Connect the Front LCR, Surround, Subwoofer, and In-Ceiling speakers with the ProA amplifier using speaker wire. Insert the wires into the connectors, making sure that the positive wire is being attached to the red connector and the negative wire is being attached to the black connector. If the negative and positive wires are switched, speaker performance will be drastically impacted.
- ***Select and set up the corresponding DSP profile to each speaker, for optimum sound and bass control. This will give a complete surround sound system, with the main speakers as well as the subwoofer(s) in place.***

***Scan the QR code below or see [docs.orginacoustics.com](https://docs.orginacoustics.com) to access the correct DSP profile.***



- Connect the amplifier to the power supply. Double check all the wiring before turning on.

**PLEASE CONTACT OUR CUSTOMER SERVICE FOR ANY INQUIRY REGARDING THE SETUP.**

## 10. TESTING THE SYSTEM

Turn on the home theater receiver / amplifier. Calibrate all the speakers in the system according to the AV receiver / amplifier's manufacturer's instructions.

### MAKING AMPLIFIER ADJUSTMENTS

- 1.** From your ProA amplifier, select the DSP profile according to the speaker that its connected. Select the correct input source and adjust the gains accordingly
- 2.** "Phase" adjustment should come next. This adjustment can have a subtle effect, but it is worth doing. You won't need to sweat getting it exact; the important thing is to avoid getting it wrong. When tuning by ear:
  - a.** If you are using a home theater receiver, during set-up there will be section asking you to enter the distance from the listener to the speakers. You should do this before proceeding. If you are using a receiver that does not have this feature, don't worry, the following steps will still get everything right.
  - b.** For source material, a test CD with an 80Hz or 100Hz test tone (either sine wave or 1/3 octave pink noise) is best but anything with constant bass can also work well.
  - c.** Set the volume so that the bass level sounds approximately right to slightly bass heavy.
  - d.** You will want to be in the critical listening area. Have a helper adjust the phase control until the bass level sounds the loudest. If you are using music or video tracks for this test, listen for the mid-bass level as the low bass will be unaffected. At this stage you're listening for the loudest bass, not the best.
- 3.** When tuning by measurement, you will use the same method as above except:
  - a.** Replace your ear with an SPL meter. An inexpensive SPL meter works fine or you can download a free app for use on your phone.
  - b.** Unfortunately, the music CD with constant bass won't work here. You will need to use a test CD.



## 11. TROUBLESHOOTING

If you have a problem, try isolating it first. For example, if you're playing a Blue-Ray and there is no sound, try connecting a music streamer to see if you get sound. If it does work, then the problem is with the television, Blue-Ray player, or the cables connecting them. If it doesn't work, the problem will be with the amplifier, speakers, or those cables.

Problem	Possible Cause
No Sound	The volume may be turned down or muted. Check the volume settings on both the amplifier and the Blue-Ray player/television/computer/etc.
No Sound	Make sure the proper source is selected on the amplifier or receiver.
No Sound	Check the cord connecting the amplifier with the source. The cord may be damaged or plugged into the wrong input or output.
No Sound	Check the wires connecting the amplifier with the speakers. Make sure they're connected properly and not damaged in any way.
No Sound	Check the ProA Gain levels using the Origin PRO Web App/ GUI
No Sound	Check the ProA Input routing using the Origin PRO Web App/ GUI
Poor Sound Quality	If you hear something like static, or the sound is cutting in and out, check the audio cables. If the problem increases when a cable is being moved, then the cable is most likely faulty or not connected properly.
Poor Sound Quality	Today's audio systems may have several places to adjust the volume, for example your MP3 player may have a volume control, and your amplifier may also have one. Check to be certain that the volume isn't turned up past 80% on any device.
Poor Sound Quality	Try changing sources to be certain that the selection you've chosen is a good quality recording.

## 12. TECHNICAL ASSISTANCE

If you have any questions or concerns about installing or using this product, you can reach us through one of the following methods:

**Phone: (844) 674 - 4461**

**Hours of operation: 8:00am - 5:00pm (Pacific Time), Mon - Fri**

**Email: [sales@originacoustics.com](mailto:sales@originacoustics.com)**

If you are having technical trouble, please include the model number and briefly explain what steps you took to resolve the problem in your email, or be prepared to answer these questions over the phone. If you are considering returning the product, it's required that you contact Ambisonic prior to any return attempts. This way we can determine if the issue can be resolved without returning the product, or if needed we can provide instructions and support for the return process.

## 13. LIMITED 5 YEAR WARRANTY

Ambisonic warrants to the original retail purchaser only that this Ambisonic product will be free from defects in materials and workmanship, provided the speaker was purchased from an Ambisonic authorized dealer.

If the product is determined to be defective, it will be repaired or replaced at Ambisonic's discretion. If the product must be replaced yet it is no longer manufactured, it will be replaced with a model of equal to or greater value that is the most similar to the original. If this is the case, installing the replacement model may require mounting modifications; Ambisonic will not be responsible for any such related costs. (Note: Origin ProA amplifier will also carry its own limited warranty, refer to its manual.)

### 13A. REQUIREMENTS & WARRANTY COVERAGE

This warranty may not be valid if the product was purchased through an unauthorized dealer. This warranty only applies to the individual that made the original purchase, and it cannot be applied to other purchases. The purchaser must be prepared to provide proof of purchase (receipt). This warranty will not be valid if the identifying number or serial number has been removed, defaced, or altered.

*\*All warranties and warranty conditions are subject to change.*

*Please refer to [www.ambisonicsystems.com](http://www.ambisonicsystems.com) for the latest information.*

## 13B. NOT COVERED BY WARRANTY

- Accidental damage
- Damage caused by abuse or misuse
- Damage caused by attempted repairs/modifications by anyone other than Ambisonic or authorized dealers
- Damage caused by improper installation
- Normal wear, maintenance, and environmental issues
- Damage caused by voltage inputs in excess of the rated maximum of the unit
- Damage inflicted during the return shipment
- Performance issues caused by modifications. ie: painting of the shell.

## 14. RETURN PROCESS

Before making any return attempts, it is required that you first contact Ambisonic customer support team. Return product to Ambisonic or your dealer, either in person or by mail. It's preferable if the product is returned in the original packaging. If this isn't possible, the customer is responsible for insuring the shipment for the full value of the product.

This warranty is in lieu of all other expressed or implied warranties. Some states do not allow limitations on implied warranties, so this may not apply depending on the customer's location. (For more information, see Magnuson-Moss Warranty Act.)



6975 S Decatur Blvd, Las Vegas, NV 89118 • [www.ambisonicsystems.com](http://www.ambisonicsystems.com) • 844-674-4461

©2025 Ambisonic. All copyrighted, trademarked and patented elements mentioned herein are the sole property of Ambisonic Systems.