

# BLENDSMBB BACK BOX



## BLENDSMBB • WOOD & METAL BACK BOX FOR CONCRETE & MASONRY INSTALLATIONS

### DIMENSIONS

Width: 16 $\frac{1}{8}$ " (410 mm)

Height: 24 $\frac{1}{16}$ " (611 mm)

Depth: 3 $\frac{15}{16}$ " (100 mm)

Each BLENDSMBB Back Box includes:

- 1 x Light Insulation
- 1 x Quick-Start Guide

### LINE DRAWINGS

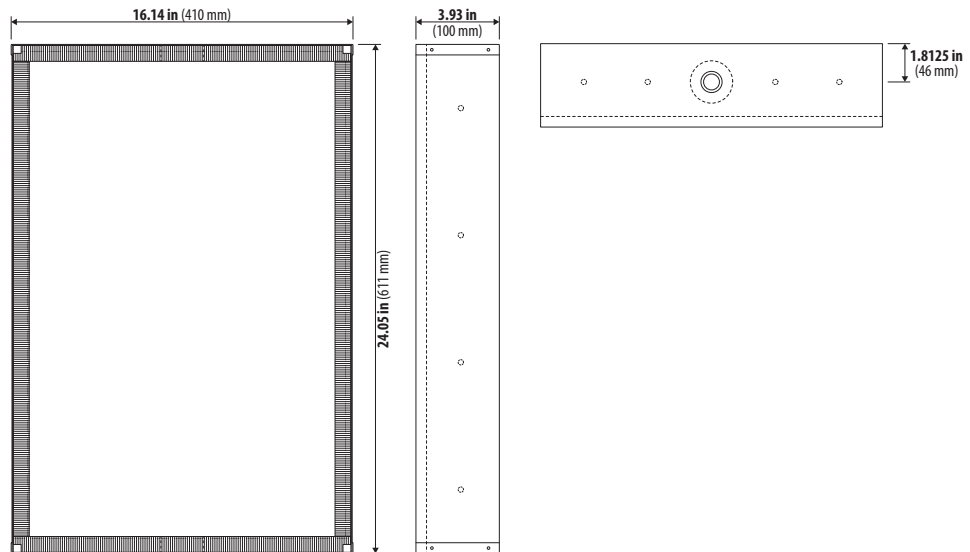

### PRODUCT APPLICATIONS

• The BLENDSMBB Metal Back Box **MUST** be installed in new construction during the pre-wire phase. The BLENDSMBB provides a solid mounting surface for any BLENDS Invisible Speaker, where there may be none otherwise. It is designed to fully surround the speaker panel, for installations into masonry, hat-channel type suspended ceilings, or any install where there is an open space behind the speaker panel, or where a metal enclosure behind the speaker is required. It also provides acoustical dampening in installations, where sound transfer from one floor or room to the next is of concern.

### PRODUCT CONSTRUCTION

• The BLENDSMBB Metal Back Box measures **3 15/16" (100 mm)** deep, is constructed of **1.2 mm metal**, and lined on all four sides with **3/4" (19 mm)** thick plywood for speaker mounting. It also arrives with one sheet of light insulation and two knock-outs for wire passage, one located at the top and bottom of the box, which will accept **1/2" (13 mm)** conduits and loom clamps.

Please visit [docs.originacoustics.com](https://docs.originacoustics.com) or scan this QR code using your smart device for the most up to date safety information and use instructions for this product.\*

\*All warranties and warranty conditions are subject to change. Please refer to [docs.originacoustics.com](https://docs.originacoustics.com) for the latest information.



## SOLID WALL INSTALLATION

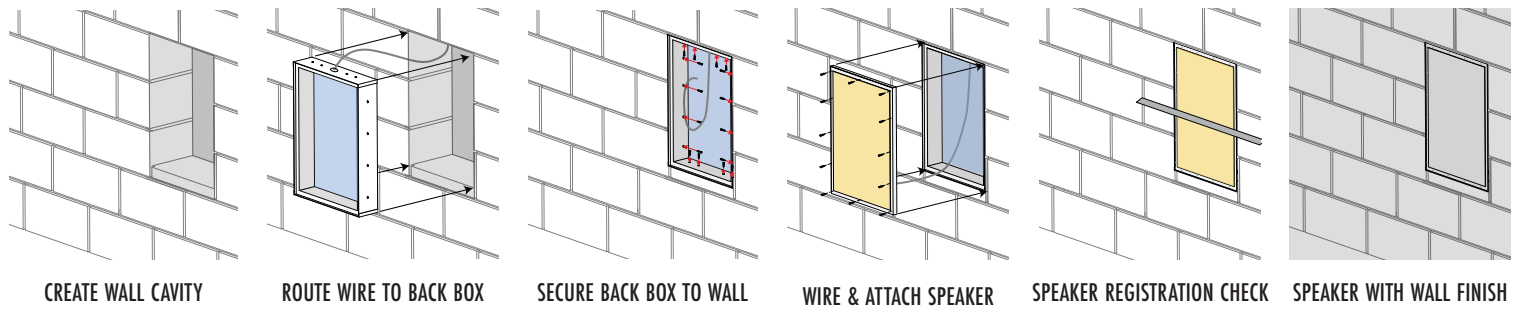

### 1. SECURE THE BACK BOX INTO CONCRETE OR MASONRY WALL

- Prepare the wall by creating a cavity to fit the BLENDSMBB Back Box. Drill through the internal wood/external metal frame as needed to screw/anchor the back box to concrete.
- Securely attach the back box to the wall, ensuring that **NO VIBRATIONS** will happen after the speaker is installed and the space is inaccessible.
- Ensure that the leading metal edge of the box is **FLUSH** with the final wall surface. **Note:** Additional materials, such as fasteners and/or bracing materials, may be necessary to securely mount the box to the masonry.

### 2. ROUTE WIRE TO BACK BOX

- Run speaker wire to each BLENDSMBB Back Box location, passing wire through the provided **½" (13 mm)** knock-outs located on the top and bottom of the box.
- **For runs of 50 feet (15m) or less, use 16 gauge wire. • For runs longer than 50 feet (15m), use 14 gauge wire.**
- Place the back box into the wall so that the edge of the box sits approximately **1/16" (1.5mm)** off the projected wall finish, and screw it securely into the wall.

### 3. PREPARE BACK BOX INSULATION

- The back box interior should always be well-insulated before the speakers are installed. Use the one piece of lightweight insulation included in the box contents. For additional acoustical isolation, you can add a viscoelastic acoustic barrier such as Dynil® by Dynamic Control ([dynamat.com](http://dynamat.com)); an ultra pliable material, measuring only 0.09" thick, which allows it to easily fit behind the speaker panels.

### 4. SPEAKER WIRING & INSTALLATION

- Connect the speaker wire to the 2P Connector. (**Pay attention to wire polarity**). Check that is properly connected to the speaker panel, and then place the speaker panel into the back box and secure in place.
- Follow BLEND S speaker installation instructions.
- To mount the speaker directly into the BLENDSMBB Back Box, it is recommended that you use the screws provided with your BLEND S speakers. **DO NOT USE NAILS. USE ONLY THE PROVIDE SCREWS. OTHER SCREWS MAY DAMAGE THE SPEAKER.**

### 5. SOUND TESTING

- Test the speaker by connecting the amplifier and playing full range audio source, to check that the speakers are functioning properly, prior to the finishing of the wall/speaker.

### 6. SPEAKER REGISTRATION & FINISHING

- Once the speaker is attached and sound tested, use a straight-edge (like a framing square) to test the BLEND S speaker panel face registration. Ensure that the center of the panel is mounted approximately **1/16" (1.5mm)** beyond the adjoining wall surface. When the straight-edge is placed across the face of the speaker panel, there should be a slight gap between the speaker and the adjoining wall surface. Adjust the panel face registration as needed and make minor adjustments using the shims included in the box of the BLEND S speaker.

**\*IMPORTANT\* DO NOT ALLOW THE SPEAKER PANEL FACE TO SIT BEHIND THE ADJOINING WALL SURFACE.**