

BOLLARD LOUDSPEAKERS



OVERVIEW

Completely unique in concept and design, the Bollard tackles the challenge of producing bass response from individual outdoor speakers in a very attractive aesthetic. While large subwoofers are often buried in the ground the requirement to have the sub somewhat close to the mid/high frequency satellites can cause some design challenges. Origin has it covered.

PRODUCT ID



LSB64RD-SILVER180
LSB64RD-SILVER360



LSB64RD-BRONZE180
LSB64RD-BRONZE360



LSB64RD-BLACK180
LSB64RD-BLACK360



LSB64SQ-SILVER180
LSB64SQ-SILVER360



LSB64SQ-BRONZE180
LSB64SQ-BRONZE360



LSB64SQ-BLACK180
LSB64SQ-BLACK360

FULL COVERAGE

The Bollard Loudspeaker includes an easy to bury integrated subwoofer. This 6.5" woofer, which ports just below the acoustic lens, adds significant bass for its relatively small size. Now, the real magic comes alive when you combine two or more Bollard Loudspeakers in one area. This network of low-end drivers produces consistent deep bass at a manageable volume all around your yard or garden.

BOLLARD LOUDSPEAKERS



ENDLESS COVERAGE

A 70V transformer with 30W, 50W and an 8 ohm tap makes the Bollard a perfect choice regardless of the size of space and number of speakers needed.



360 DEGREES OF SOUND

The Landscape Bollard also utilizes a 4½" down-firing driver with two dispersion options. One is allowing sound to project 360° from the enclosure. The second is accomplished with an insert to limit the sound to half of the dispersion or 180°. that disperses in either omni-directional 360-degree or 180-degree patterns. This way, the low and high frequencies cover the same amount of area with virtually no difference in sound quality, regardless of your orientation to the sound system.

ALUMINUM SLEEVES

We use durable fluorocarbon coatings to finish our high-quality aluminum sleeves. This method delivers resistance to moisture, heat, and the sun while maintaining the aluminum's natural beauty. Both sleeve styles are available in three colors, natural silver, black, and bronze, and have a five-year warranty.



BOLLARD LOUDSPEAKERS

SPECIFICATIONS

LSB64RD | LSB64SQ

Part	LSB6400RD LSB6400SQ
Woofer	6 1/2" (165mm) Polypropylene
Midrange	4 1/2" (114mm) Aluminum
Tweeter	1" (25mm) PEI
Frequency Response	48HZ - 20kHz
Power RMS Peak	60W 100W
Impedance	6 Ohm (Sub) / 4 Ohm (Sat)
Transformer Taps	70V-50W/25W
Sleeve Diameter	5 1/2" (140mm) RD 5 3/4" X 5 3/4" (146 X 146 mm) SQ
Sleeve Height	18 3/4" (476mm)
Subwoofer Diameter	12 1/2" (317mm)
Subwoofer Enclosure Height	8 1/2" (215mm)

ALL MODELS

Colors	Silver Bronze Black
Dispersion	360° or 180°
Sleeve Height	18 3/4" (476 mm)

LINEDRAWINGS

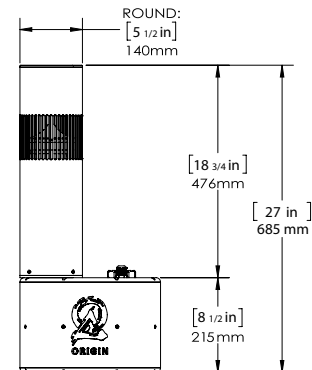
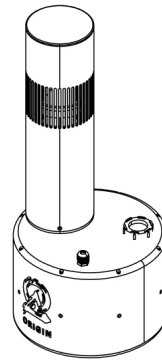
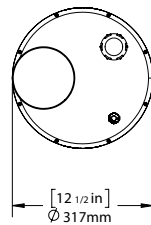

LSB64RD

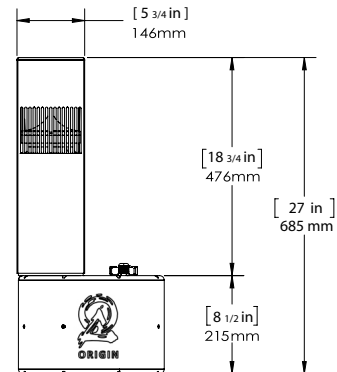
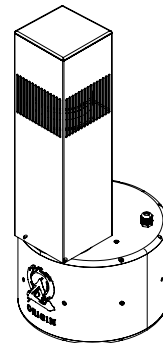
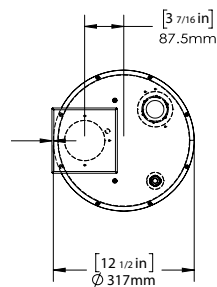

LSB64SQ



Please visit docs.originacoustics.com or scan the QR code using your smart device for the most up to date specifications and use instructions for this product. Products may only be purchased through an authorized integration partner.